

THE FIRST-EVER BMW i4.

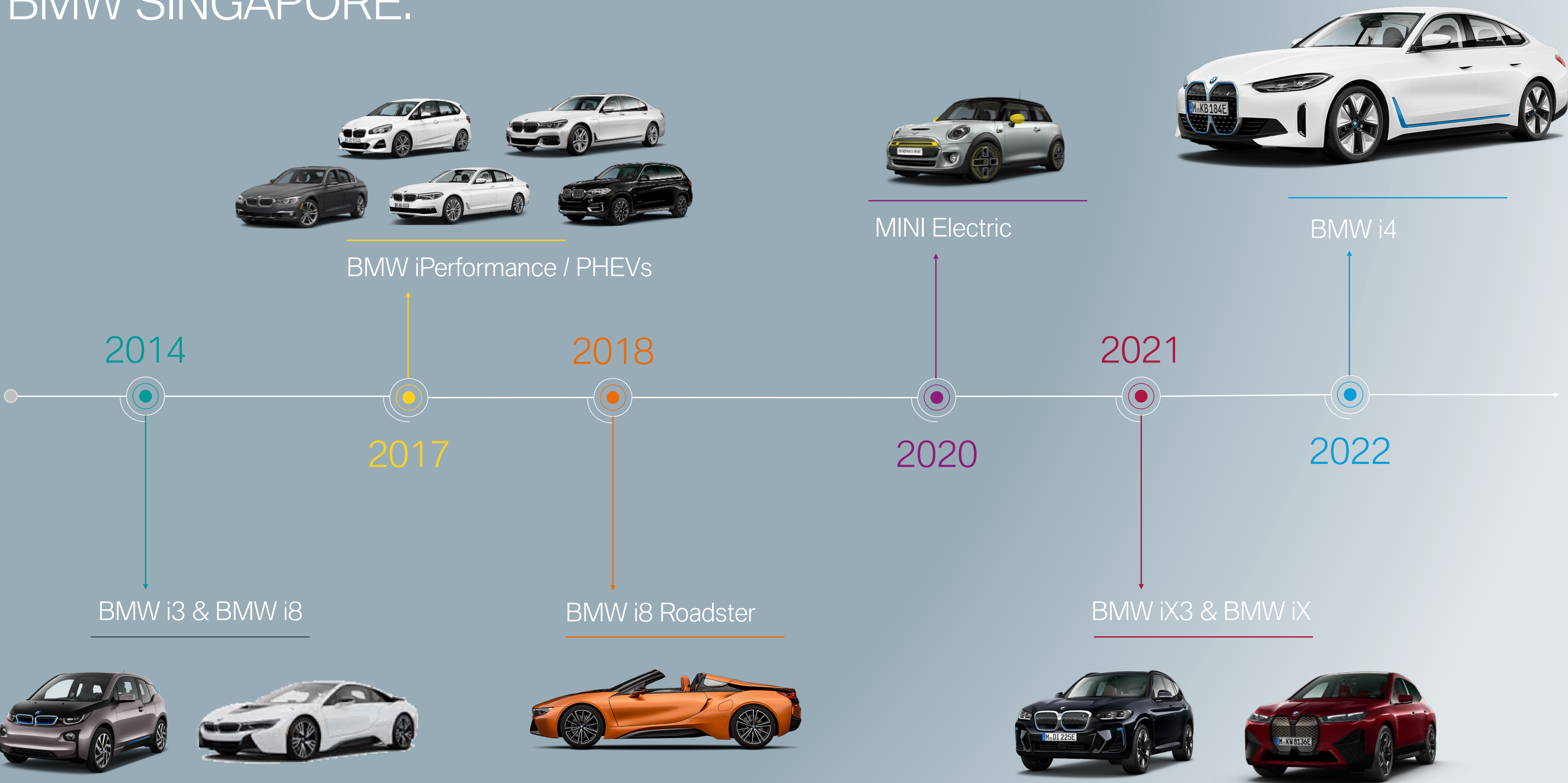

ELECTRIFICATION TIMELINE. BMW SINGAPORE.



360 ELECTRIFICATION PACKAGE.



- Environmentally friendly
- High recovery rate
- Circular economy - The process creates a closed-loop, reusing raw materials from end-of-life batteries that can be used for new products.



Shell
Recharge 

- 3 years free charging up to 10,000kWh at Shell Recharge
- OR**
- Comprehensive home charging

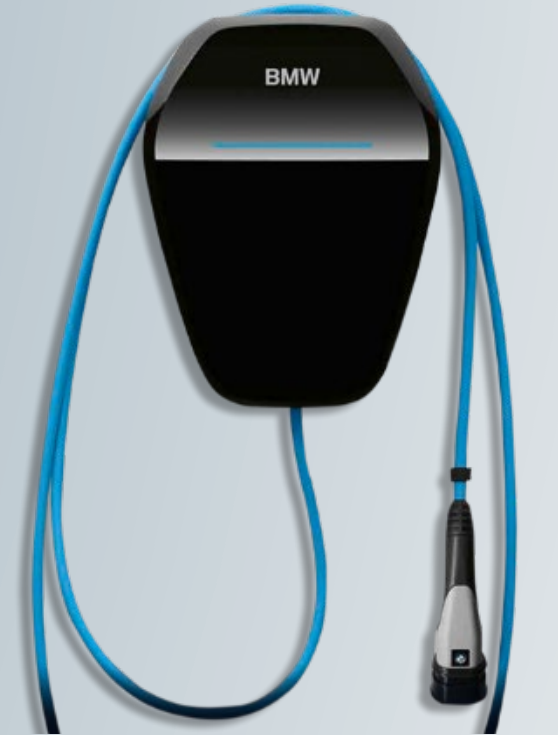

TRAINING

DELIVERED AS PROMISED: THE BMW GROUP LAUNCHES THE NEXT BIG STEP IN THE TRANSFORMATION TOWARDS E-MOBILITY.

BMW iX FOCUS:

- New technology kit for automated driving, incl. new features.
- Interior of the future.
- High end connectivity.
- Extended sustainability.

SHARED FEATURES:

- BMW eDrive GEN5.
- BMW Operating System 8
- Next generation cockpit.
- Perfect digital offer.

BMW i4 FOCUS:

- The ultimate driving machine.
- Long distance driving comfort.
- Elegance and practicability.
- First ever BEV from BMW M.



THE FIRST-EVER BMW i4 MARKS A CORE MOMENT FOR THE COMPANY.

- It all began from the BMW VISION NEXT 100, to the 2017 BMW i Vision Dynamics.
- The aim: a four-door sporty saloon packed with everything the future can bring.
- The BMW i4 is built with an electric-first development strategy in the BMW home plant.



THE FIRST-EVER BMW i4. FORM AND FUNCTION COMING TOGETHER.

Frameless windows and
integrated door handles

Clean frontend design

- Best of a 4-door sedan and an expressive coupe in one.
- Sleek kidney grille for BMW heritage and accommodating camera, ultrasonic + radar sensors.

19-inch aerodynamic
wheels with low rolling
resistance tyres



THE FIRST-EVER BMW i4. FORM AND FUNCTION COMING TOGETHER.

Clean surfacing,
with precise lines and
strong shoulders

Liftback rear to access
470 litres
of cargo space

BMW i blue accents

Distinctive aero diffuser –
for efficiency, and the
promise of highly
dynamic driving



THE FIRST-EVER BMW i4. THE ULTIMATE ELECTRIC DRIVING MACHINE.

DESIGN.

- Pure emotion through sporty proportions with Gran Coupé character.



SPORTINESS & COMFORT.

- Perfect quartet between driving dynamics, elegance, comfort and long distance driving.

ELECTRIC DRIVING PLEASURE.

- Amazing acceleration, high range and adaptive recuperation system.

USER EXPERIENCE & CONNECTIVITY.

- Intuitive user interface and IconicSound - driving with all senses.

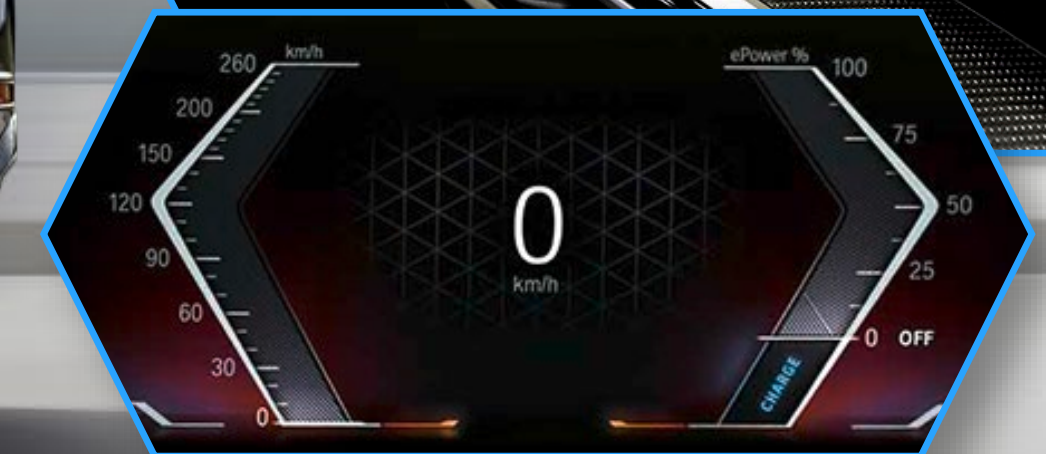

BMW eDRIVE COMPETENCE SINCE 2008 – IN FOUR GENERATIONS.

- Electrification journey began in 2008 with the MINI e, up to plug-in hybrid models of today.
- Continuous development of efficiency, dynamics, and sustainability.

BMW GEN1 AND GEN2

MINI e



BMW Concept Active E



BMW GEN3

BMW i3



BMW GEN4

BMW 225xe | BMW 530e | BMW 330e



PRODUCTION OF ELECTRIC DRIVETRAINS: HIGH LEVEL OF IN-HOUSE COMPETENCE.

Electric Drivetrain (BMW Gen5)

Conventional Drivetrain

BMW Group in-house effort

Suppliers

Highly integrated drivetrain unit:
electric motor, transmission and power electronics.

Lithium-ion
high voltage battery.

Combustion engine.
Assembling

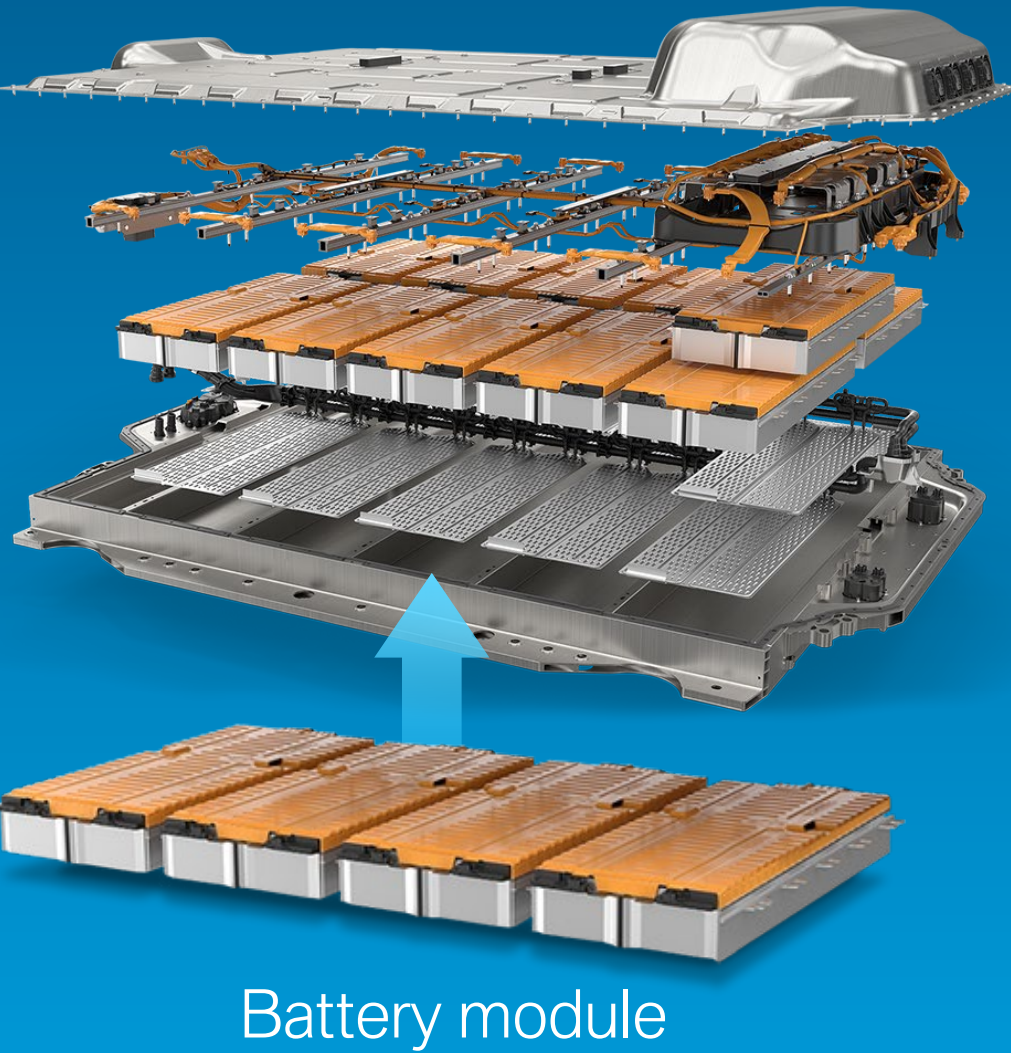
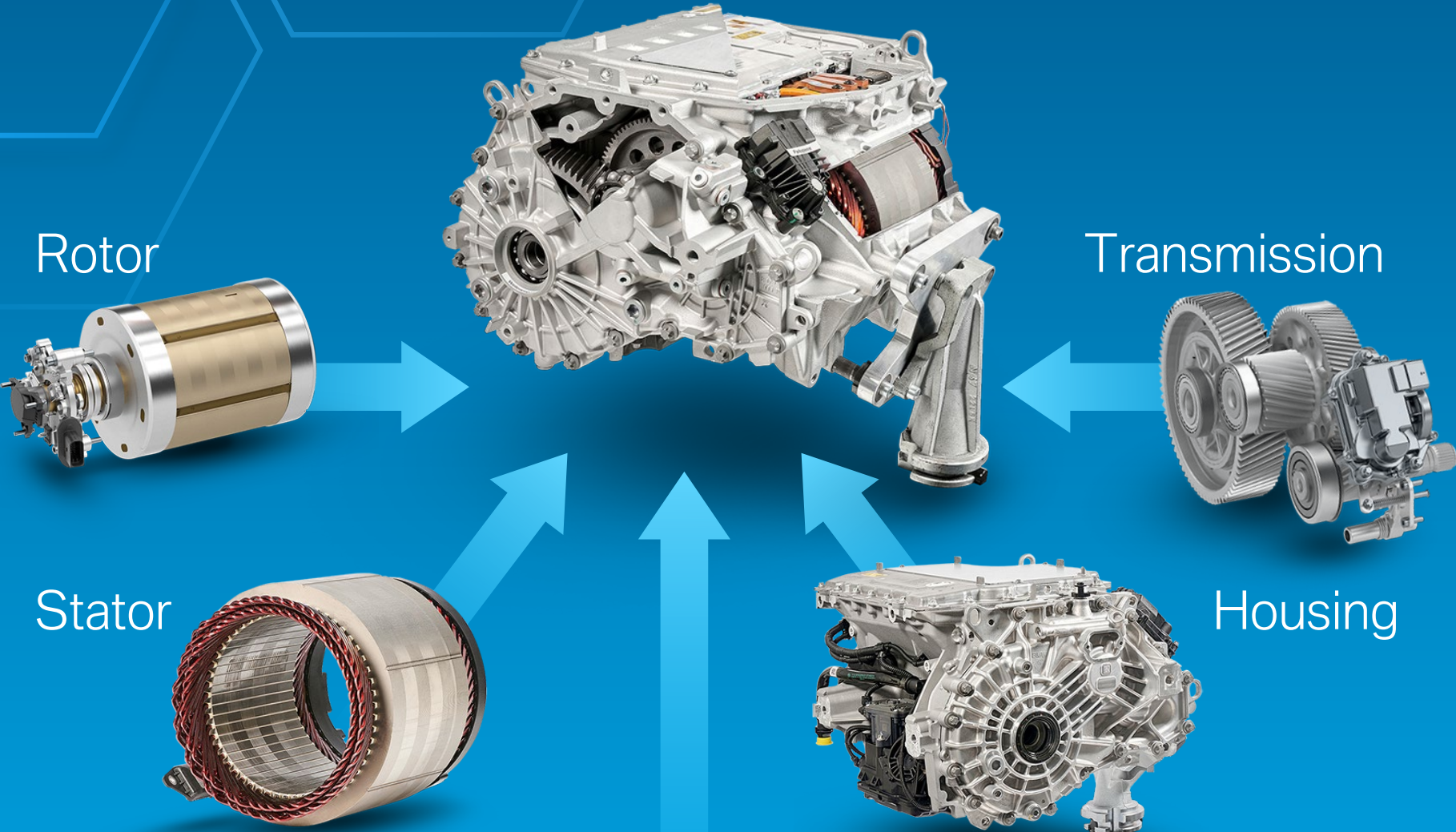

Power
electronics

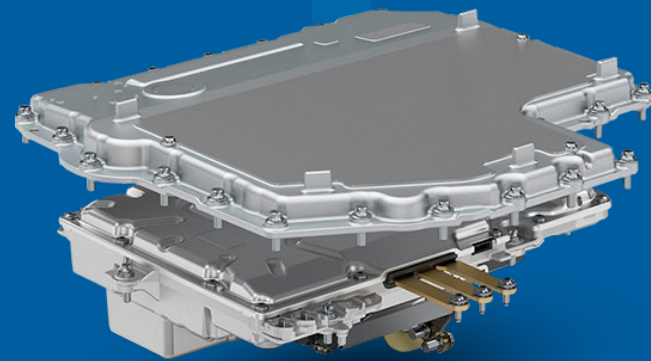

Components according
to BMW requirements

Battery
cell



Crankshaft

Crankcase

Con-rods

Cardan
shaft

Rear-axle
transmission

Cylinder
head

Engine components
Main transmission
Exhaust system
Tank
....

THE FIRST-EVER BMW i4. FIFTH GENERATION eDRIVE.

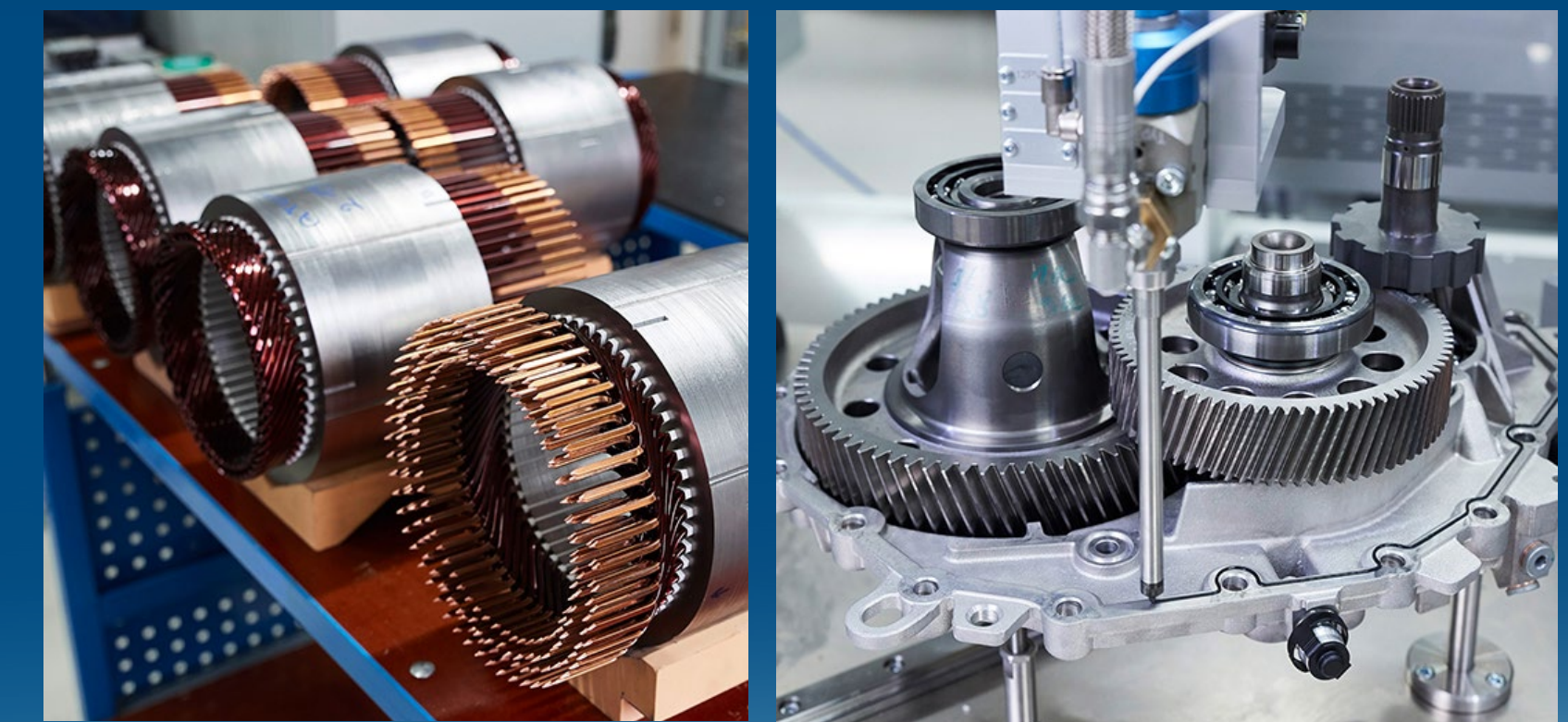
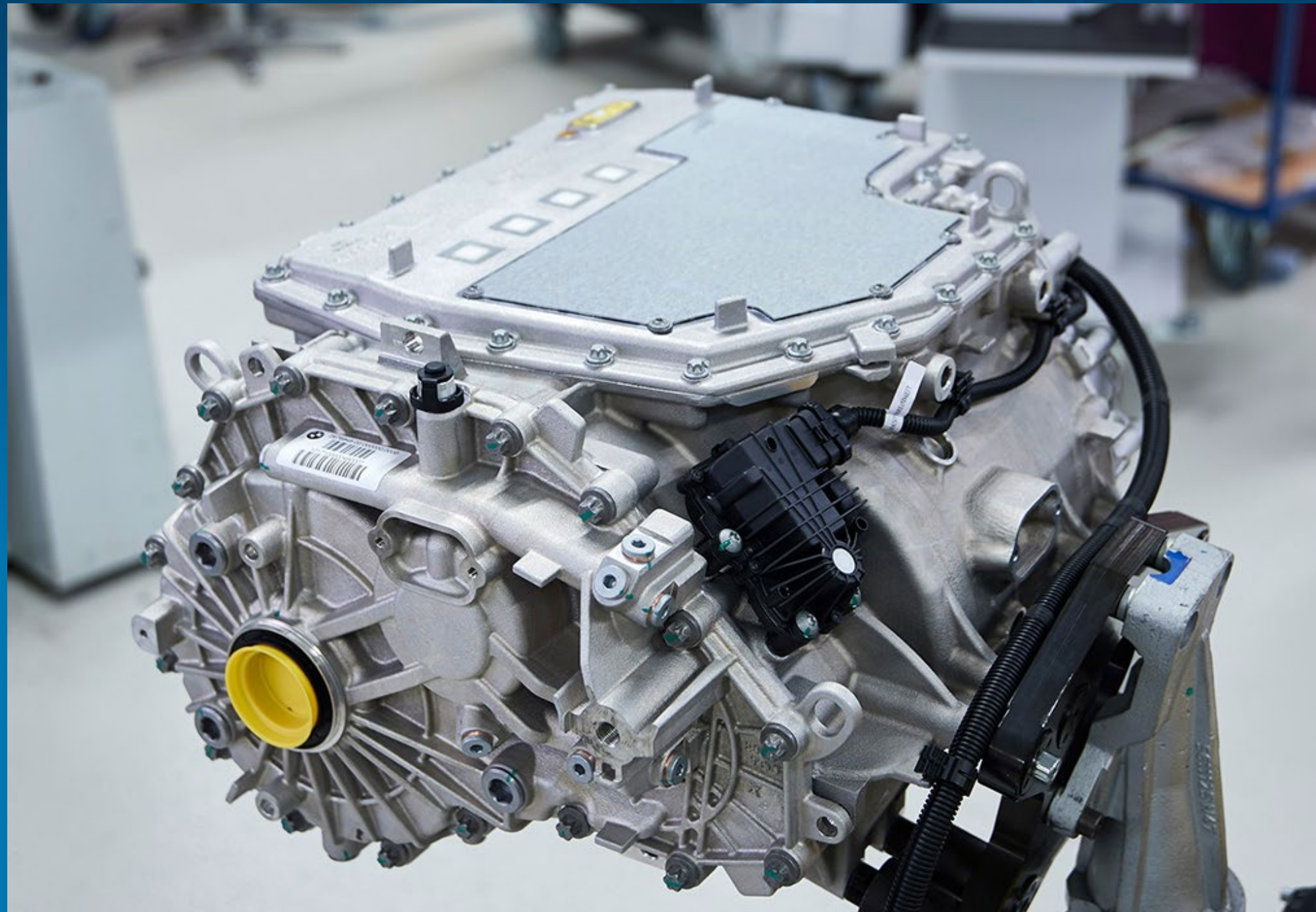

- In-house development and production of batteries since 2008.
- Further optimisation of interaction between the electric motor, transmission, power electronics, and battery.
- Electric motor without the use of rare earths.

- Electric motor, transmission and power electronics in a compact unit.

THE FIRST-EVER BMW i4. 5TH GENERATION HIGHLY INTEGRATED DRIVE UNIT.

➤ ESM Technology: Electrically excited Synchronous Motor:

- Silent operation, exceptional balance between high peak power and stable torque even at high rpm.
- Avoids magnets and therefore rare-earth materials.

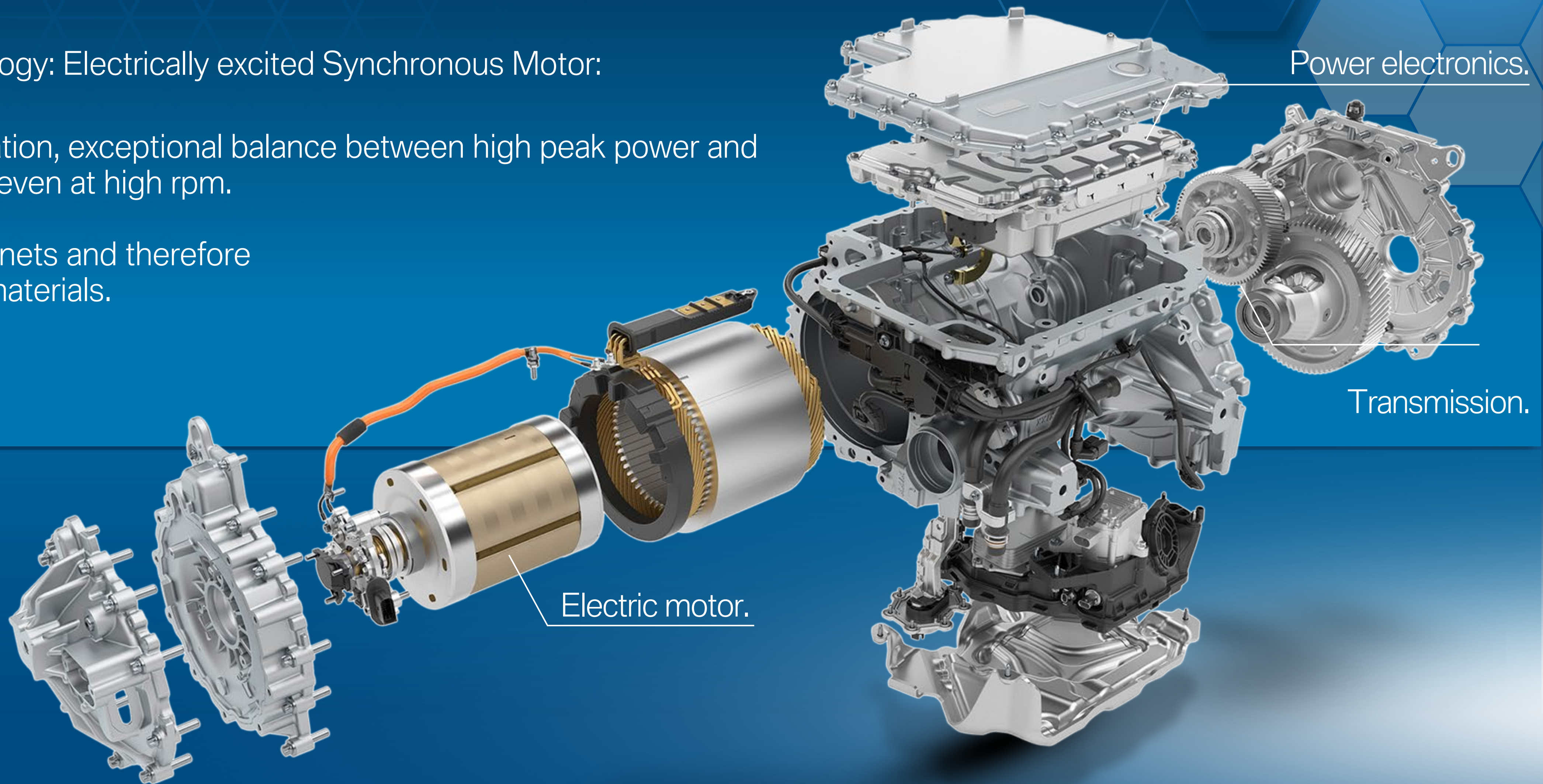

THE FIRST-EVER BMW i4. ADVANCED BATTERY CELL TECHNOLOGY.

- Modular System: e.g. allowing with a 110mm cell a Gran Coupé silhouette for the BMW i4 or with a 140mm cell a SAV silhouette for the BMW iX.
- Lithium-ion technology with Prismatic cells with Nickel-rich cell chemistry.
- Each cell individually controlled and modules easy to exchange.

Cell-surveillance.

Cell modules.

Battery
Management Unit.

Cooling plates.

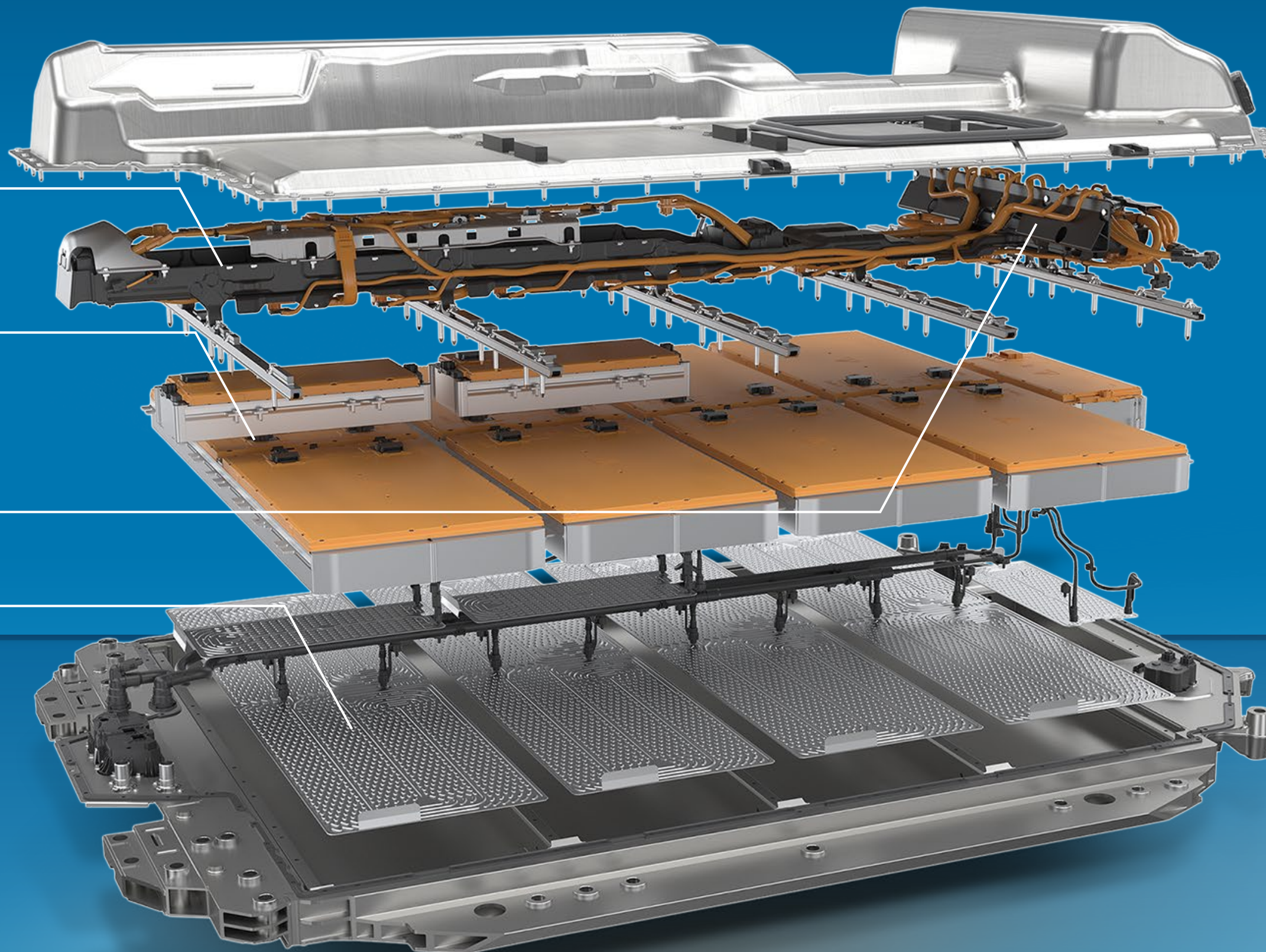

BMW i4 ENERGY CAPACITY

BMW i4 (eDrive40
and M50)

83.9 kWh (gross)
80.7 kWh (net)



BMW GEN5: HIGH VOLTAGE BATTERY – SUSTAINABILITY FOCUSED.

- BMW steered and controlled Cobalt and Lithium sourcing.
- CO₂-free production of battery cells - only using green power.
- Our target: use of more than 90% recycled Nickel, Cobalt and Aluminium by 2030.

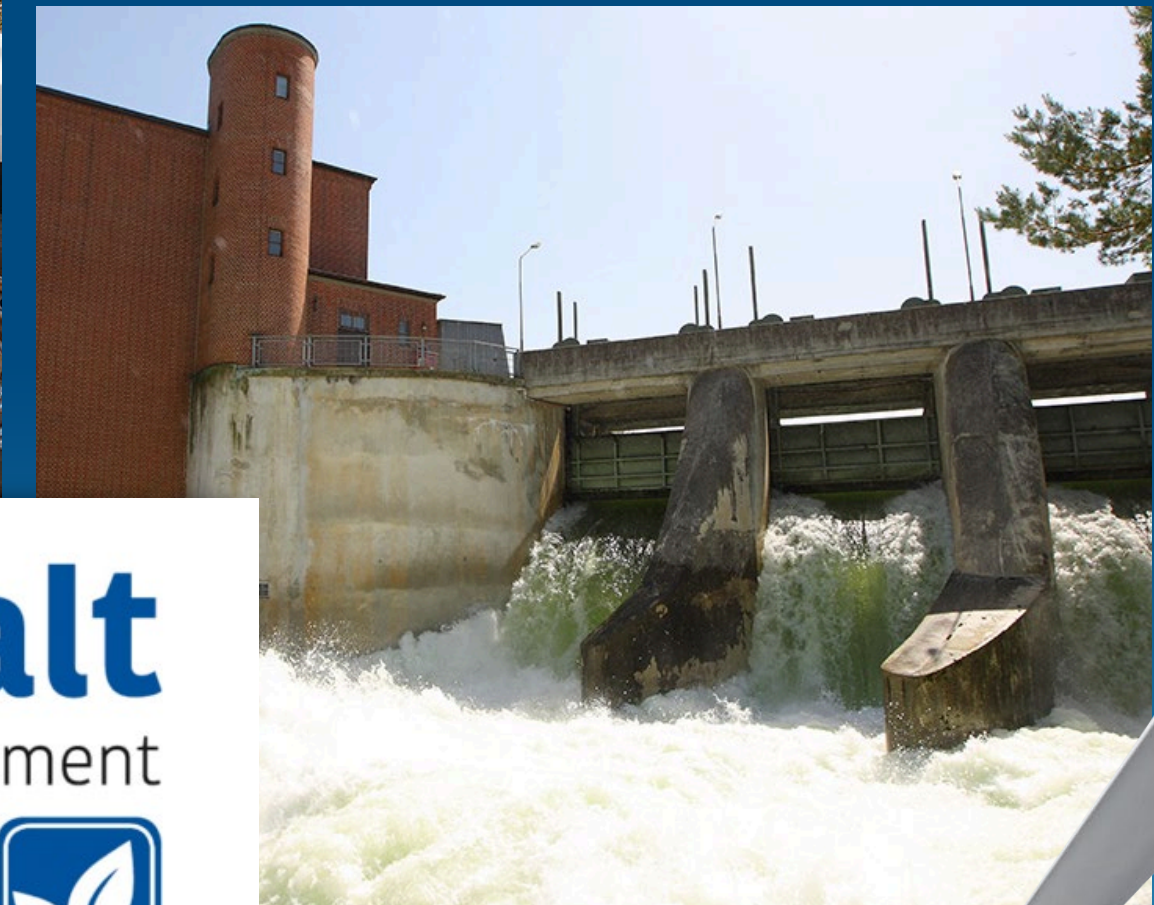
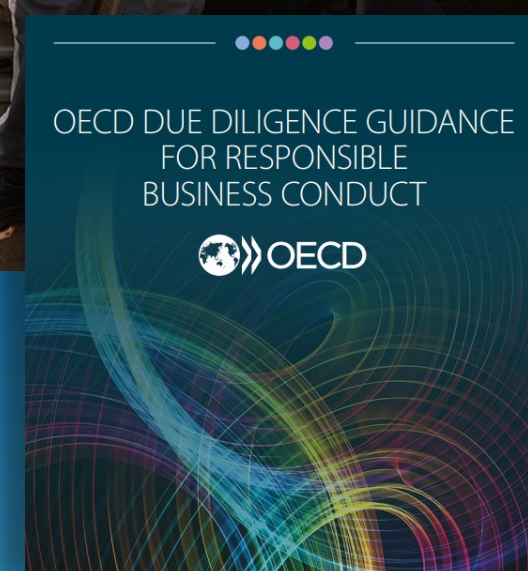

THE FIRST-EVER BMW i4. GEN5 E-DRIVETRAIN PERFORMANCE & EFFICIENCY.

Adaptive recuperation
during coasting and braking;
up to 116 kW

205 kW DC / 11 kW AC
charging (3-phase)

Highly integrated
drivetrain unit
250 kW / 340 hp
electric motor,
transmission and
400 V electronics, free
from Rare Earth Materials

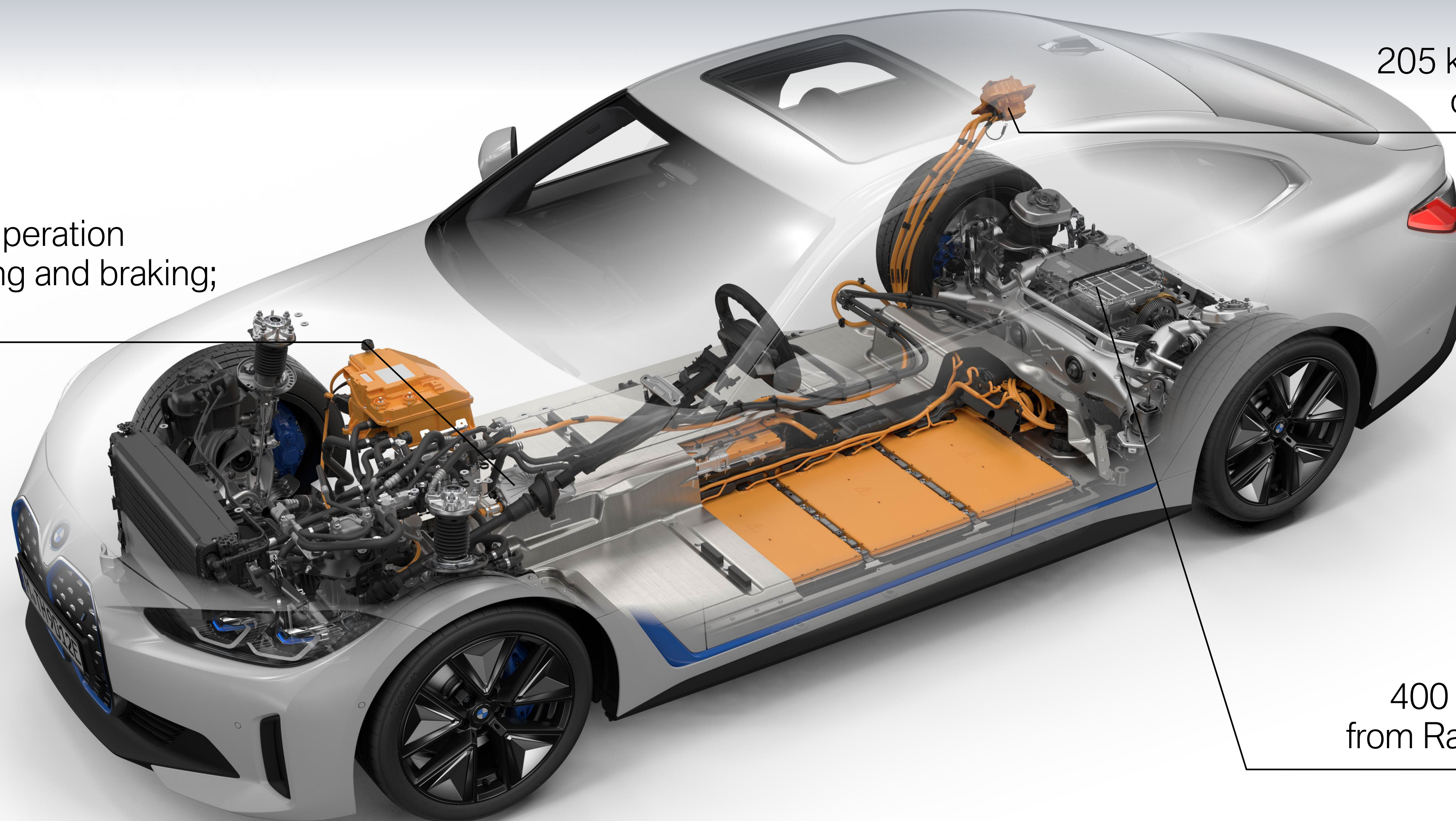

THE BMW i4 eDrive40. PERFORMANCE AND CHARGING.

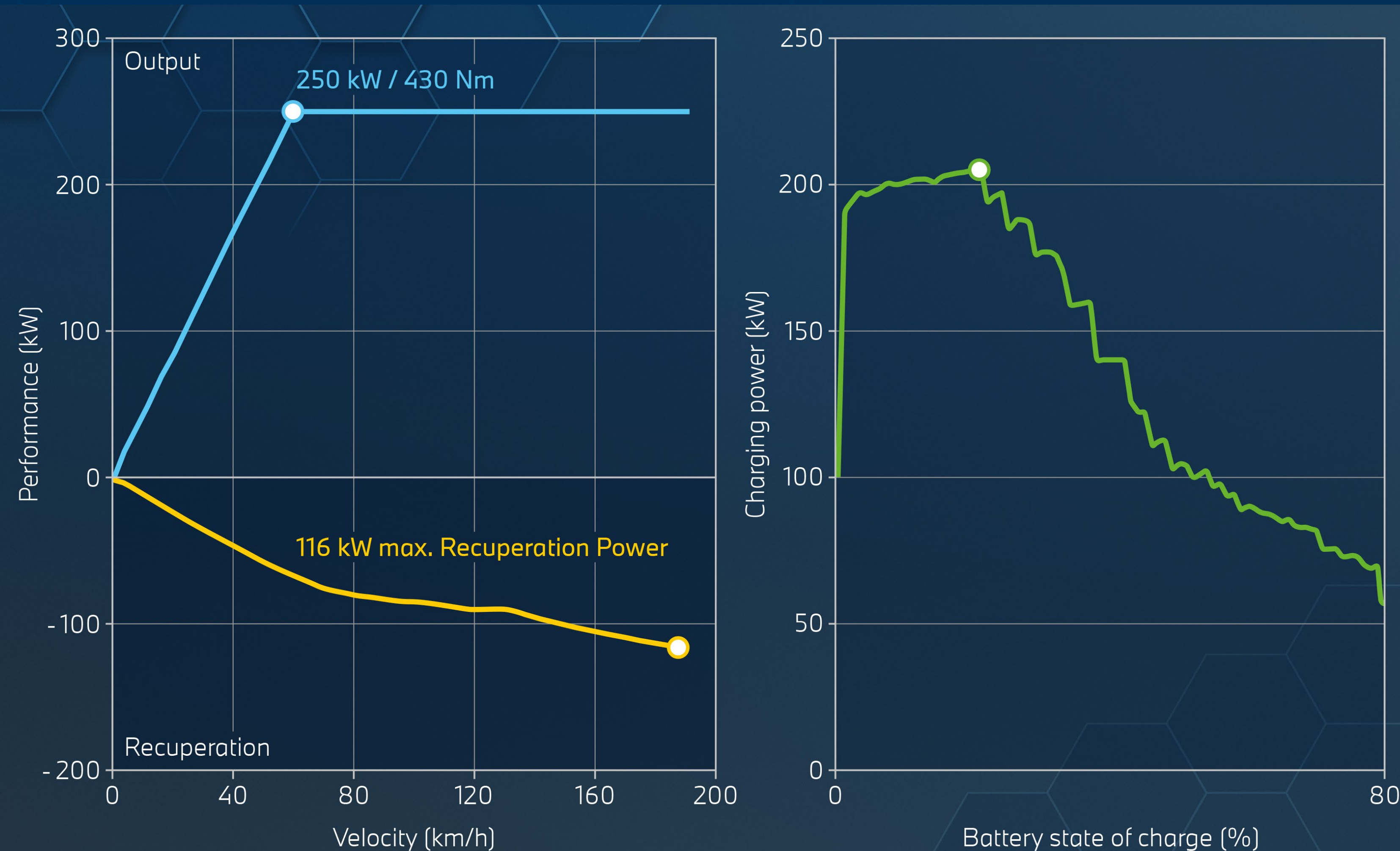

BMW i4 eDrive40 -
Charging duration

10 mins high-power
charging (DC):
+ 164 km range

10% - 80% high-
power charging (DC):
31 mins

THE FIRST-EVER BMW i4. CHASSIS TECHNOLOGY.

Additional precisely interlinked bracing elements for enhanced driving dynamics by increased longitudinal and torsional stiffness of the body structure

Increased track width*

➤ 26 mm front

➤ 12 mm rear

Rear axle with
air springs

Bracing
elements for
the rear axle

37 mm lower center
of gravity compared
to BMW 3 Series

Increased negative camber at front axle

* In comparison
to BMW 3 Series

45.1 / 54.9 % axle load distribution

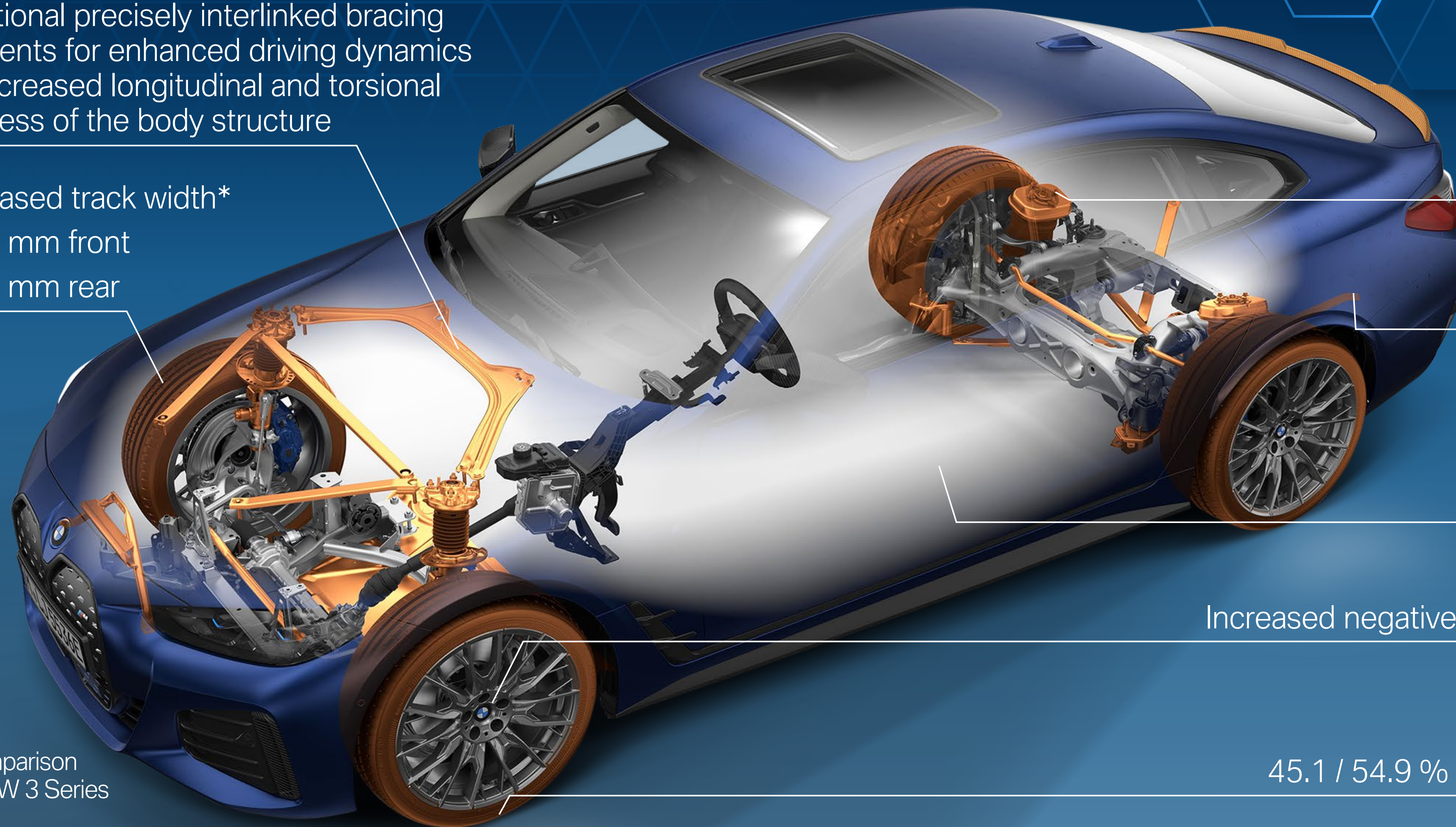

ACTUATOR CONTIGUOUS WHEEL SLIP LIMITATION FOR REAR WHEEL DRIVE AND ALL-WHEEL DRIVE VEHICLES.

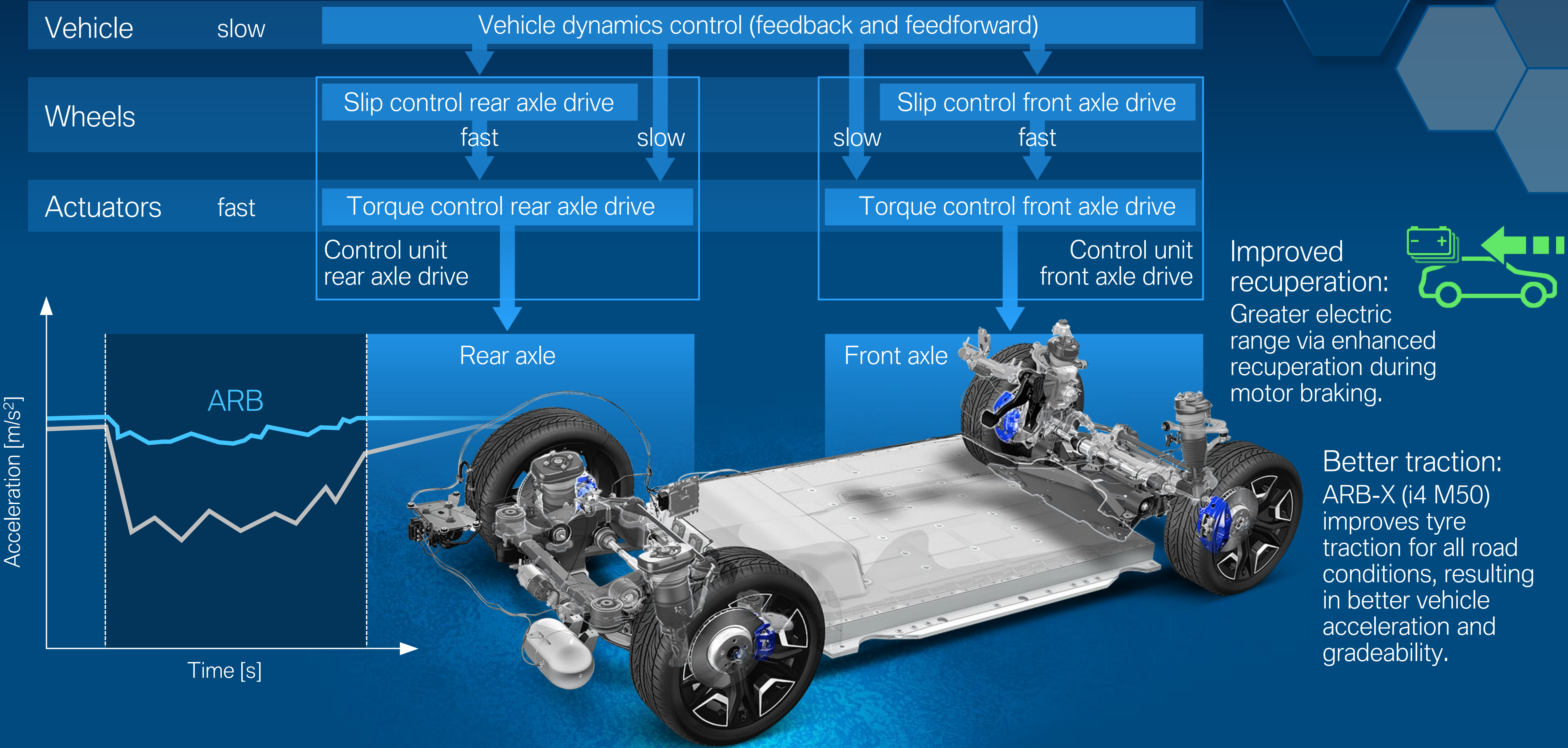

THE FIRST-EVER BMW i4. INTEGRATED BRAKE.

Integration of the braking interface, force amplification and the brake control system (DSC) in one compact, light-weight brake module.

Components of a conventional brake system.

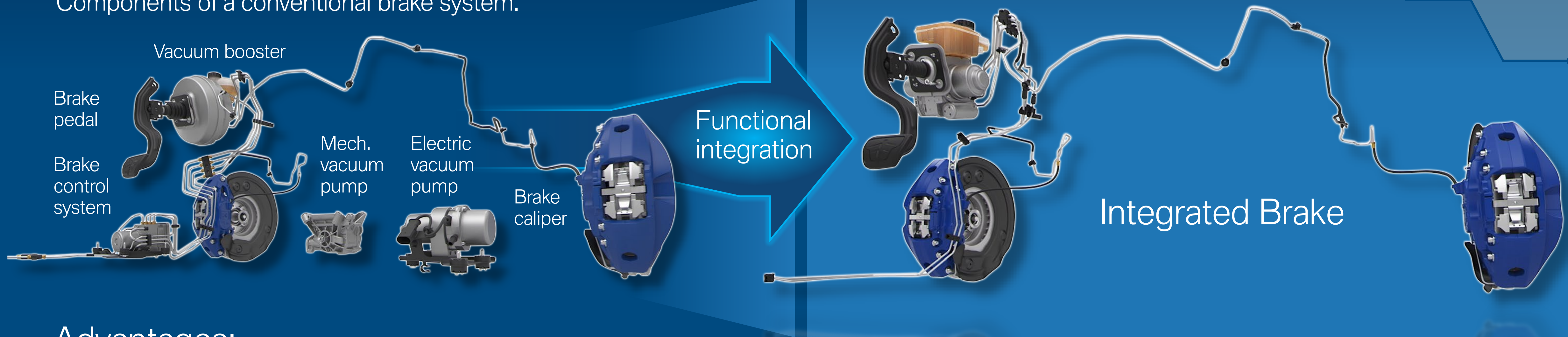

Advantages:

- Improved sportiness and sense of safety due to the short, direct pedal feel.
- Fast balancing between regenerative braking and friction braking → optimal recuperation and maximized driving stability.
- Higher levels of driving dynamics and controllability through swift and precise control of the brakes for vehicle stabilization.
- Shorter stopping distances during active driver-assistance functions, improving active safety.

A consistent brake pedal feel is guaranteed. Regardless of recuperation.

THE FIRST-EVER BMW i4. DIGITAL EXCELLENCE.

- BMW Curved Display (12.3" instrument cluster, 14.9" Control Display).
- New generation of BMW Head-Up Display.
- BMW Operating System 8.
- Wide range of driver assistance systems.
- Latest connectivity features.
- BMW IconicSounds Electric by Hans Zimmer.



THE FIRST-EVER BMW i4. THE ALL-NEW BMW iDrive.

BMW Intelligent Personal Assistant.

- Driver- and Co-Driver dialogue.
- Enabled with BMW ID sign-in.
- Proactive suggestions.

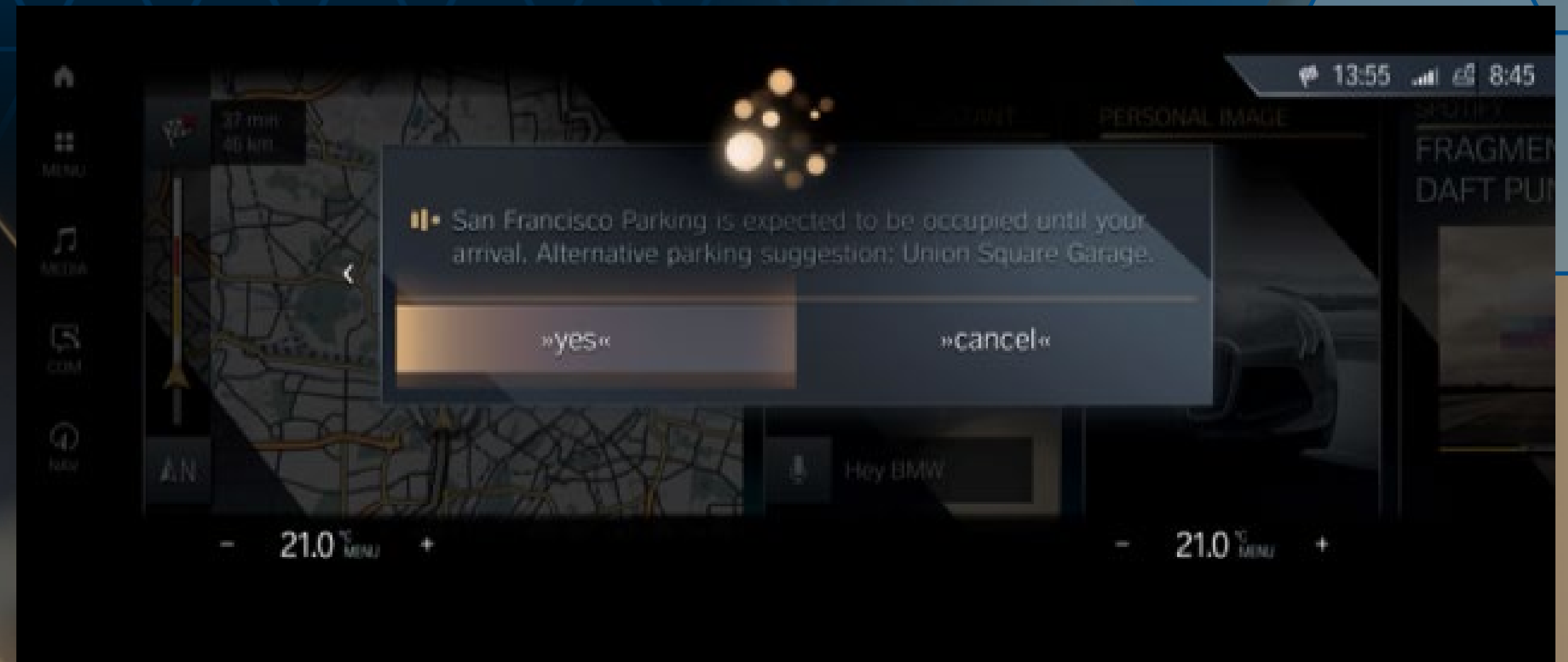
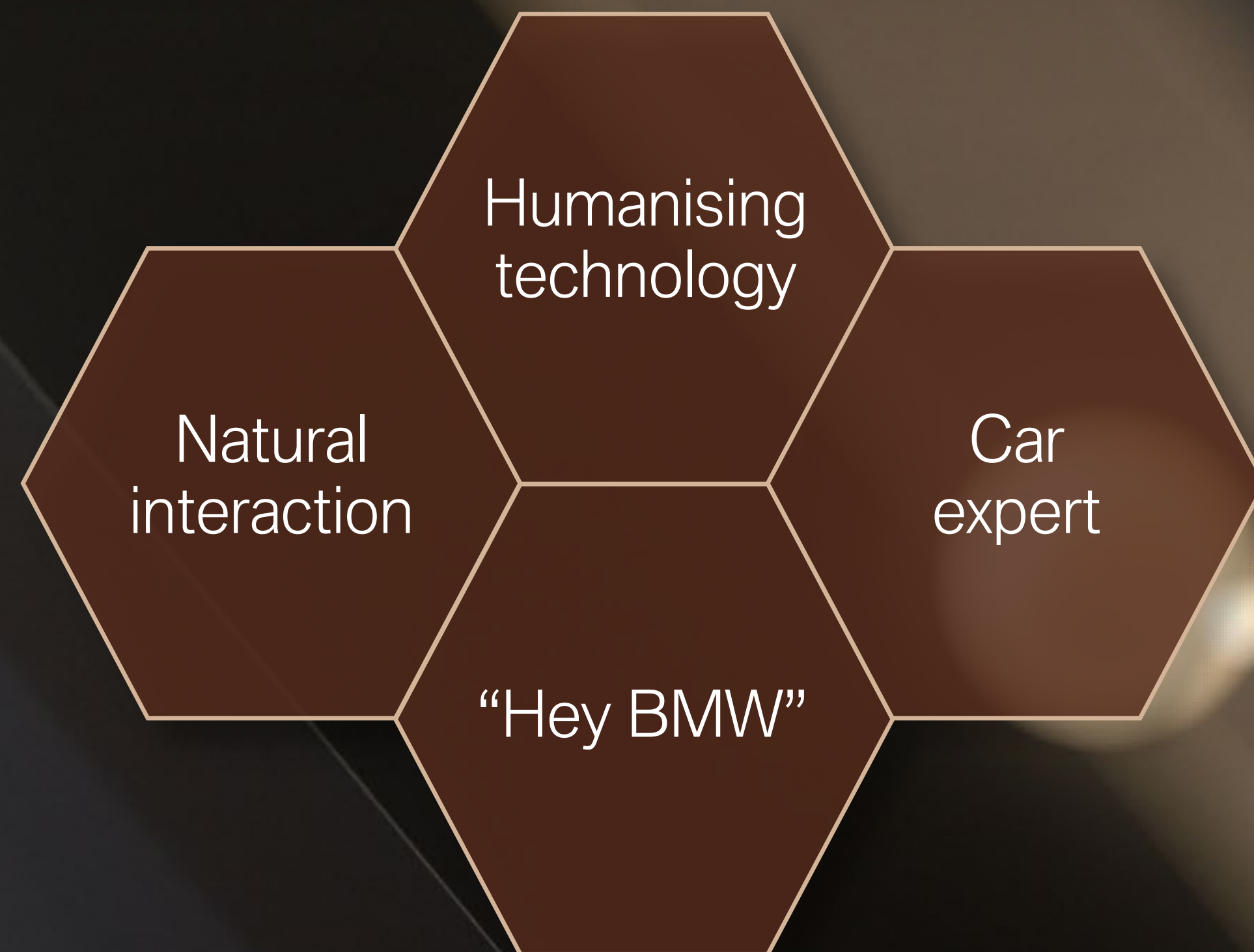

THE FIRST-EVER BMW i4. TWO OFFERS IN SINGAPORE.



BMW i4 eDrive40

250 kW / 340 hp

430 Nm

5.7 seconds

up to 590 km

19.7 kWh/100 km

11 kW / 205 kW

164 km

A1

\$311,888

Now



BMW i4 M50

400 kW / 544 hp

795 Nm

3.9 seconds

up to 521 km

22.5 - 18.0 kWh/100 km

11 kW / 205 kW

140 km

TBA

TBA

Q3 2022

Power

Torque

Acceleration (0 - 100 km/h)

Range (WLTP)

Energy consumption (WLTP)

Max. AC/DC charging power

Added range per 10 mins max. DC charging

VES band

Price at launch with COE

Availability

THE BMW i4 M50 – COMING SOON.
WHERE i AND M MEET.

True M Performance
More agility More precision
More emotion



- Standard equipment for the BMW i4 M50 also includes:
- Adaptive M Suspension.
 - M Sport Brake.
 - M Aerodynamic Package.
 - M Interior.
 - M-specific BMW IconicSounds.

THE FIRST-EVER BMW i4. BMW CHARGING – PACKAGE DETAILS.

Home charging package (landed properties)

- AC wallbox solution
- Wallbox installation service
- Instant access to all stations on the Shell Recharge network with RFID card

Public charging package (high-rise living)

- 3-year or 10,000 kWh subscription package at Shell Recharge stations
- Installation service of Shell Recharge station at shared carpark (if approved)
- Instant access to all stations on the Shell Recharge network with RFID card



THE FIRST-EVER BMW i4. BMW CHARGING.

- Control of all charging features in car and via My BMW App.
- Finding the right charging point and timing your charge.



Start Climatization

Do you want to start climatization now?
Remote functions may take few minutes.

CANCEL

START

- Remote control for charging process and vehicle pre-conditioning for the journey.
- Push-notification when target charge is reached or irregularities occur.
- Route-planning with charging stops.

