

THE FIRST-EVER BMW i4 M50.



WIDE PORTFOLIO OF
FULL-ELECTRIC OFFERINGS.



THE FIRST-EVER BMW i4 M50.
THE BEST OF BOTH WORLDS.

True M Performance

More precision

More agility

More emotion



- Adaptive M Suspension.
- M Sport Brake.
- M Aerodynamic Package.
- M-specific BMW IconicSounds.

THE FIRST-EVER BMW i4 M50. POSITIONING.



BMW 430i Gran Coupé



BMW M440i xDrive Gran Coupé



BMW i4 eDrive 40 Gran Coupé



BMW i4 M50 Gran Coupé



THE FIRST-EVER BMW i4 M50. SINGAPORE OFFER.



BMW i4 eDrive40

250 kW / 340 hp

430 Nm

5.7 seconds

up to 590 km

19.7 kWh/100 km

11 kW / 205 kW

164 km

A1: \$25,000 rebate

\$338,888



BMW i4 M50

400 kW / 544 hp

795 Nm

3.9 seconds

up to 521 km

23.1 kWh/100 km

11 kW / 205 kW

140 km

A2: \$15,000 rebate

\$412,888

Power

Torque

Acceleration (0 - 100 km/h)

Range (WLTP)

Energy consumption (WLTP)

Max. AC/DC charging power

Added range per 10 mins max. DC charging

VES band

Price with COE

THE FIRST-EVER BMW i4 M50. HIGHLIGHTS.

Perfect quartet of driving dynamics, elegance, comfort, and long-distance driving.

Weight-minimised,
extremely stiff Gran Coupé
body structure

Intelligent kidney grille
accommodating camera,
ultrasonic + radar sensors.

BMW LaserLights



THE FIRST-EVER BMW i4 M50. HIGHLIGHTS.

Slim high-voltage battery,
low cell height of 110mm

Clean surfacing,
with precise lines and
strong shoulders

Liftback rear, cargo
space of 470 litres



THE FIRST-EVER BMW i4 M50. GEN5 E-DRIVETRAIN PERFORMANCE & EFFICIENCY.



Rear axle electric
motor 230 kW

Front axle electric
motor 190 kW

205 kW DC / 11 kW AC
charging (3-phase)

Highly integrated
drivetrain unit
400 kW / 544 hp
electric motor,
transmission and
400 V electronics, free
from rare earth materials

Adaptive Recuperation during
Coasting and Braking; up to 195 kW

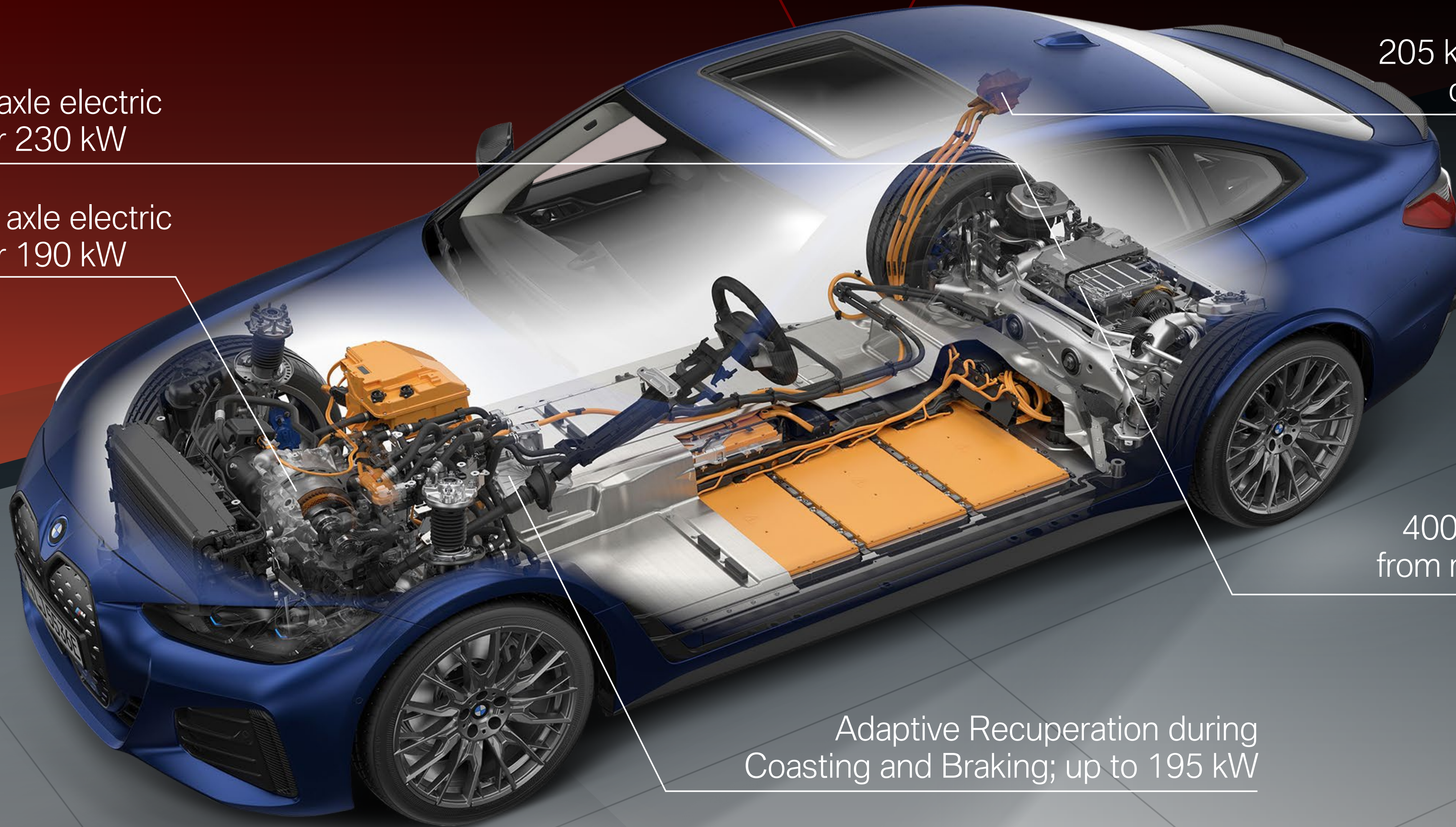

THE FIRST-EVER BMW i4 M50 CHASSIS.* THE FIRST ELECTRIC BMW M PERFORMANCE MODEL.



Additional precisely interlinked bracing elements = increased longitudinal and torsional stiffness of body structure

Increased track width*

➤ 26 mm front

➤ 12 mm rear

Gurney flap for reduced aerodynamic lift

Rear axle with air springs

Bracing elements for rear axle

37 mm lower center of gravity*

Adaptive M Suspension including VDC dampers and Variable Sports Steering

Increased negative camber at front axle

48.2 / 51.8 % axle load distribution

*In comparison to BMW 3 Series.

THE FIRST-EVER BMW i4 M50. AIR PERFORMANCE WHEELS.

➤ Effective reduction of air turbulence in the area of the wheels.

Weight reduction of ~15% compared to conventional alloy

➤ wheels

Innovative design combines optimised

➤ aerodynamic properties with elegance
of an aluminium rim

BMW i4 M50 wheel options.

19" option



19" option



20" option



THE FIRST EVER BMW i4 M50.
FIFTH GENERATION eDRIVE.



THE FIRST-EVER BMW i4 M50. BMW CHARGING.

- Control of all charging features in car and via My BMW App.
- Finding the right charging point and timing your charge.



Start Climatization

Do you want to start climatization now?
Remote functions may take few minutes.

CANCEL

START

- Remote control for charging process and vehicle pre-conditioning for the journey.
- Push-notification when target charge is reached or irregularities occur.
- Route-planning with charging stops.

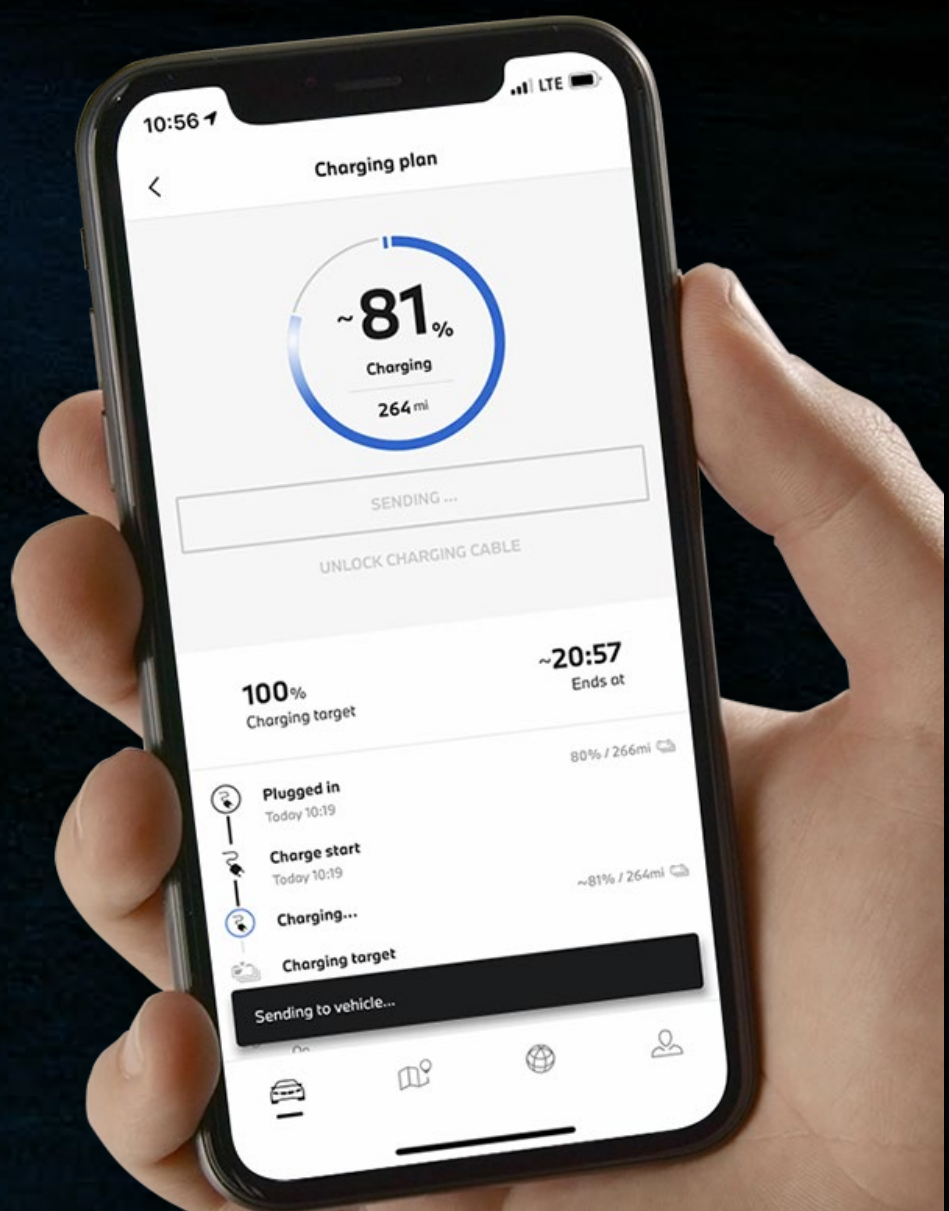
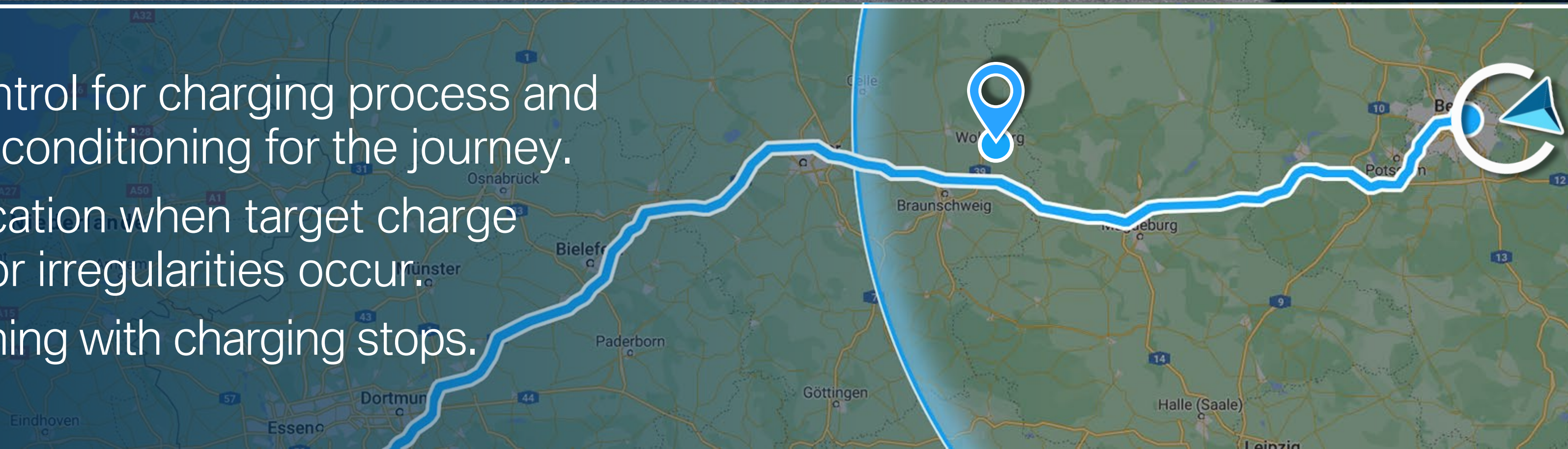

BMW CHARGING. PACKAGE DETAILS.

Home charging package (landed properties)

- AC wallbox solution
- Wallbox installation service
- Instant access to all stations on the Shell Recharge network with RFID card

Public charging package (high-rise living)

- 3-year or 10,000 kWh subscription package at Shell Recharge stations
- Installation service of Shell Recharge station at shared carpark (if approved)
- Instant access to all stations on the Shell Recharge network with RFID card



THE FIRST-EVER BMW i4 M50. PERFORMANCE AND CHARGING.

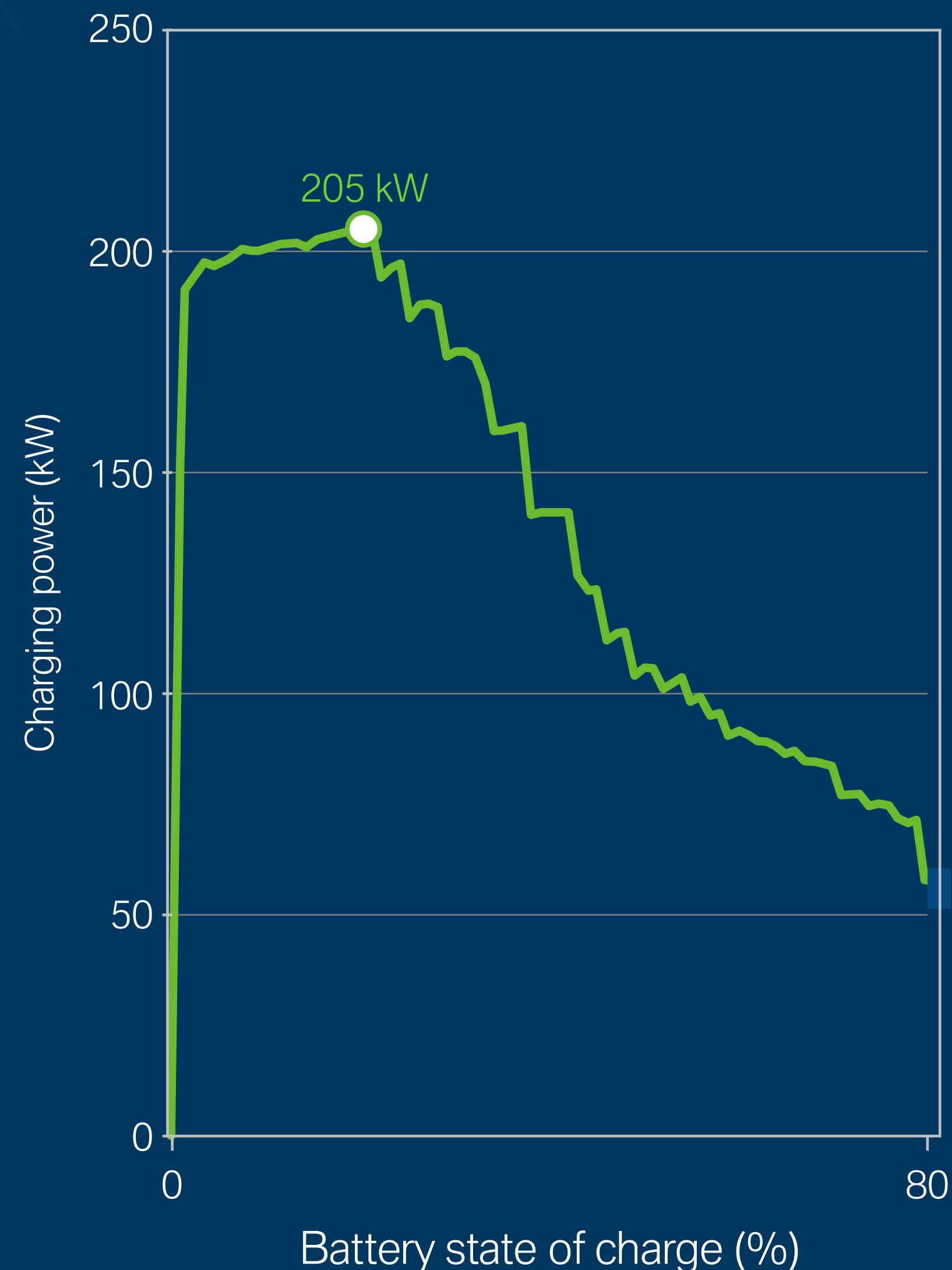
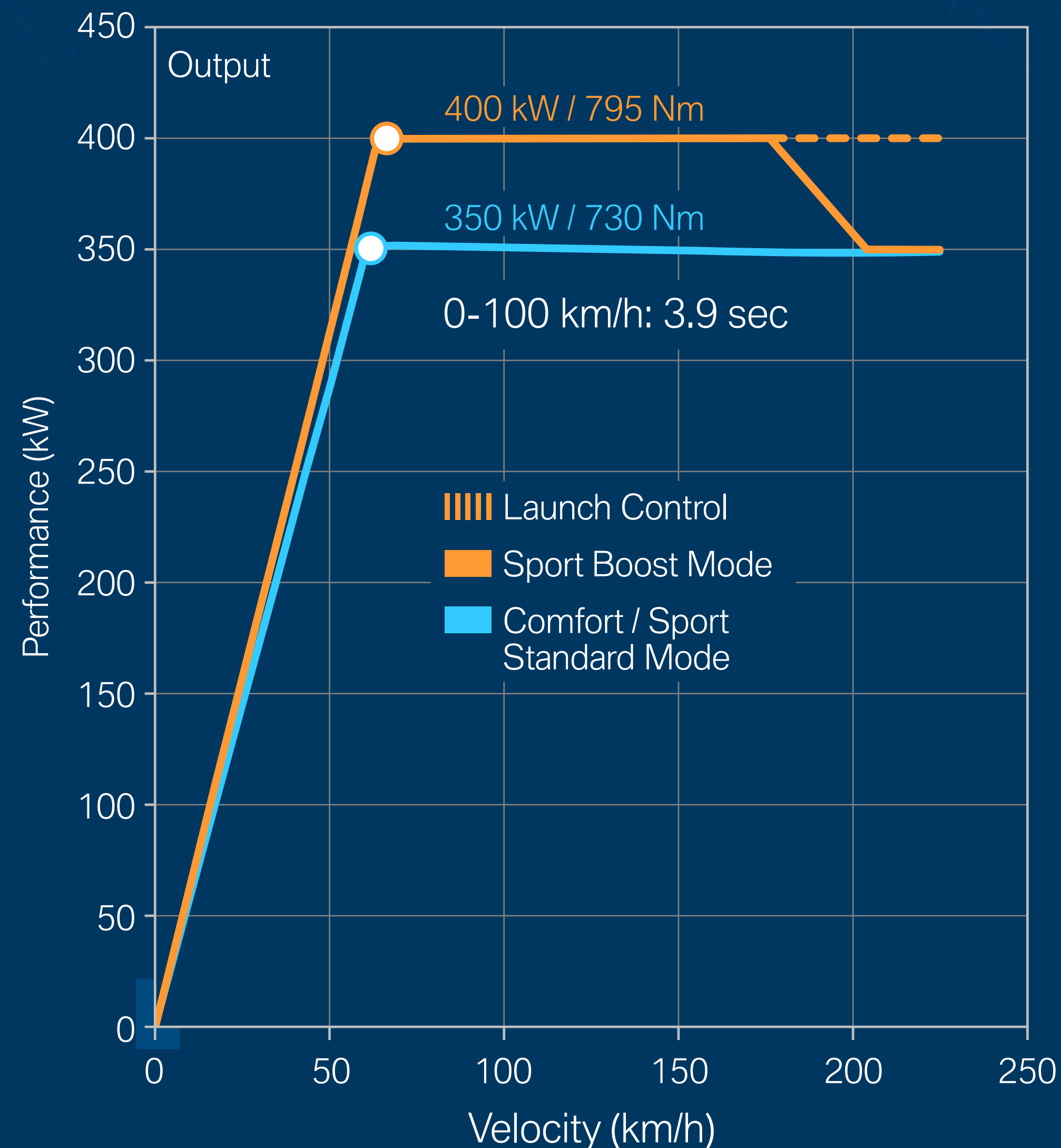

BMW i4 M50 -
Charging duration

10 mins high-power
charging (DC):
+ 140 km range

10% - 80% high-
power charging (DC):
~31 mins

Max rate of 195 kW
recuperation power.

BMW eDRIVE COMPETENCE SINCE 2008 – IN FOUR GENERATIONS.

- Electrification journey began in 2008 with the MINI e, up to plug-in hybrid models of today.
- Continuous development of efficiency, dynamics, and sustainability.

BMW GEN1 AND GEN2

MINI e



BMW Concept
Active E



BMW GEN3

BMW i3



BMW GEN4

BMW 225xe | BMW 530e | BMW 330e



PRODUCTION OF ELECTRIC DRIVETRAINS: HIGH LEVEL OF IN-HOUSE COMPETENCE.

Electric Drivetrain (BMW Gen5)

Conventional Drivetrain

BMW Group in-house effort

Suppliers

Highly integrated drivetrain unit:
electric motor, transmission and power electronics.

Lithium-ion
high voltage battery.

Combustion engine.
Assembling

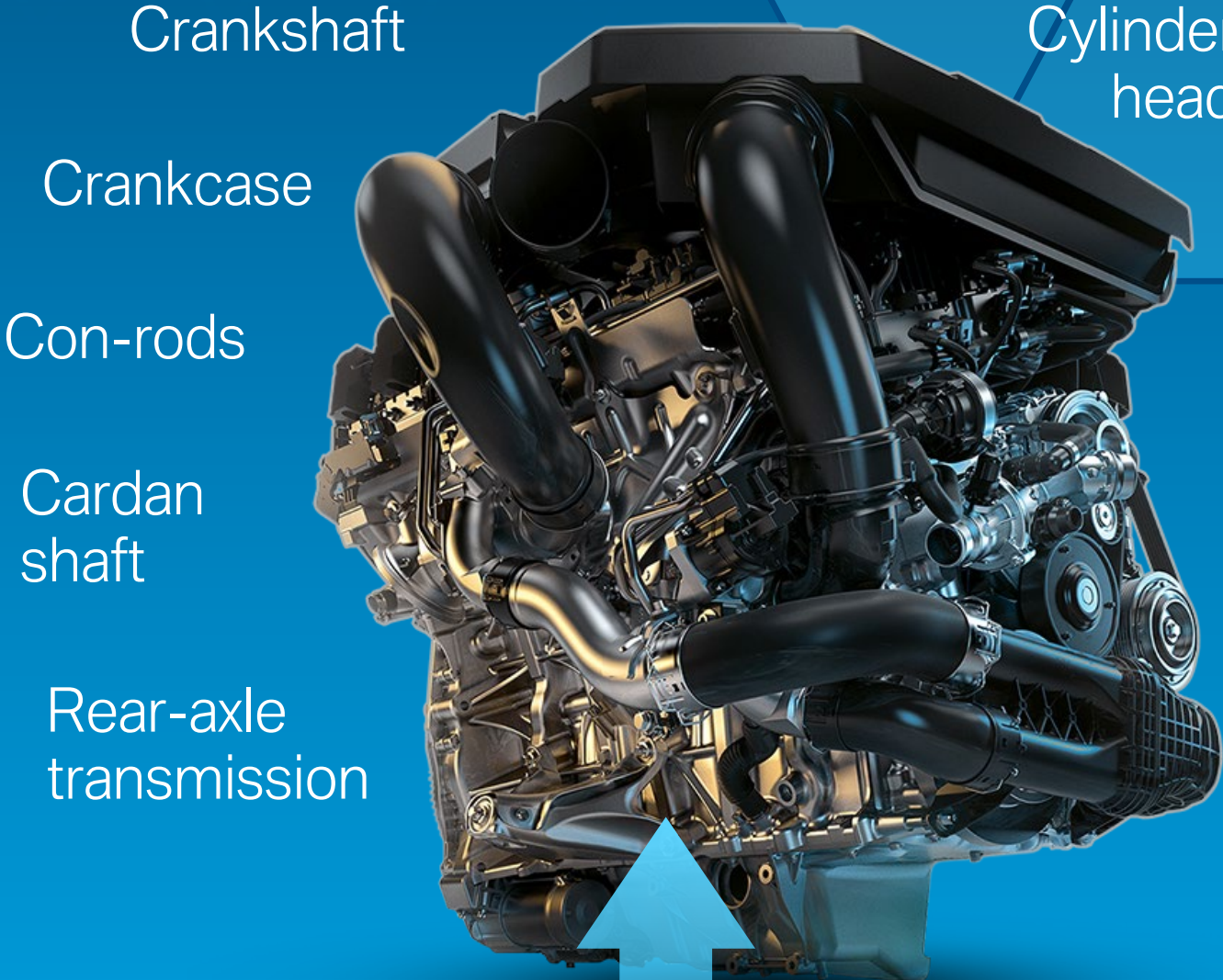
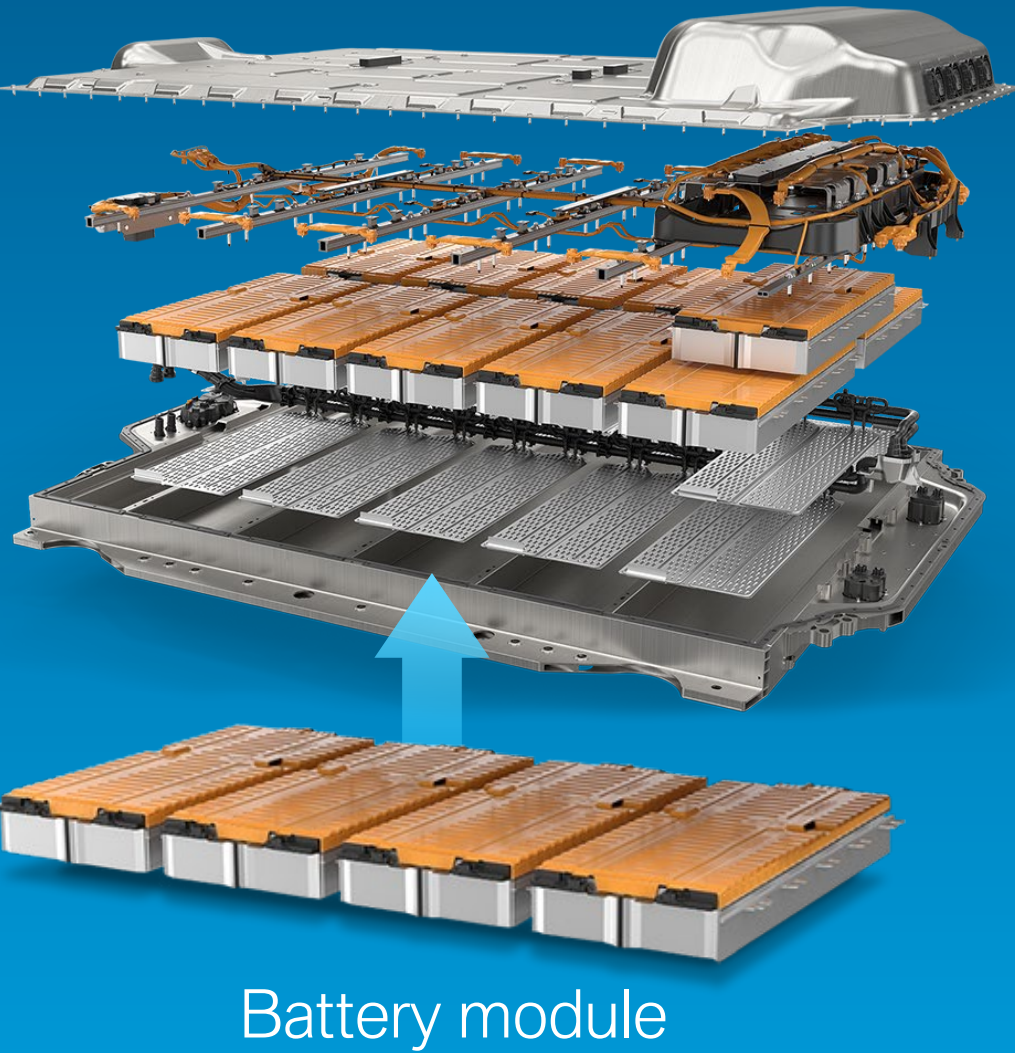
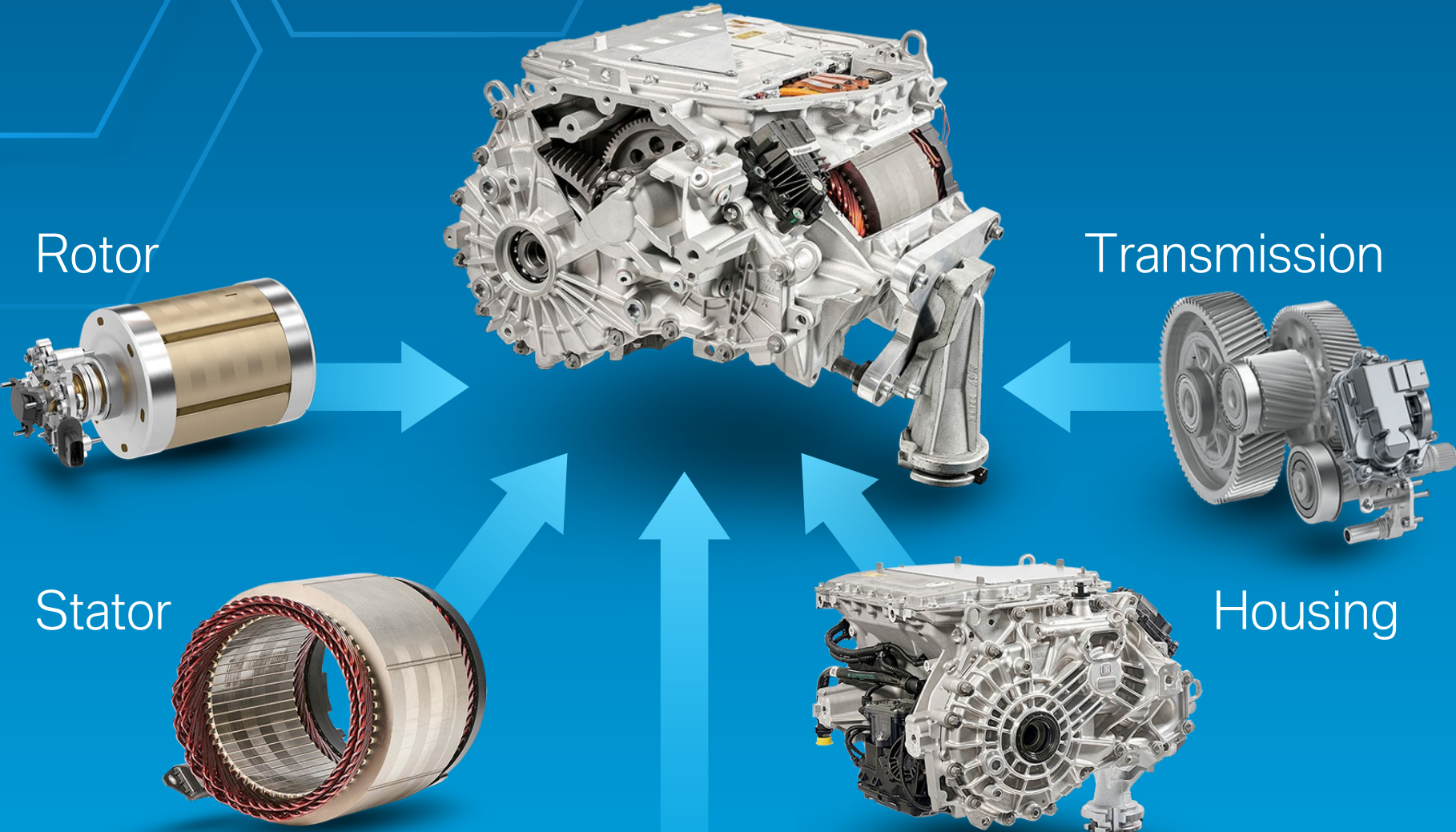

Power
electronics

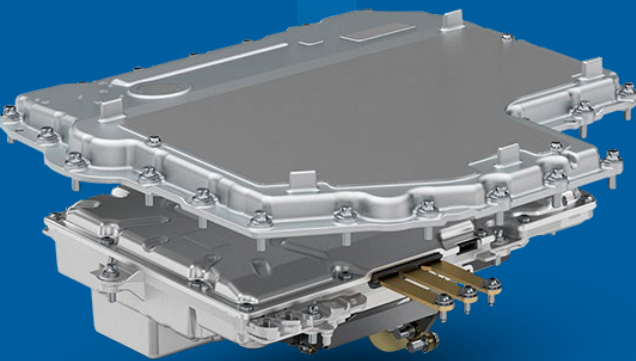

Components according
to BMW requirements

Battery
cell



Engine components
Main transmission
Exhaust system
Tank
....

THE FIRST-EVER BMW i4 M50. eDRIVE TECHNOLOGY.

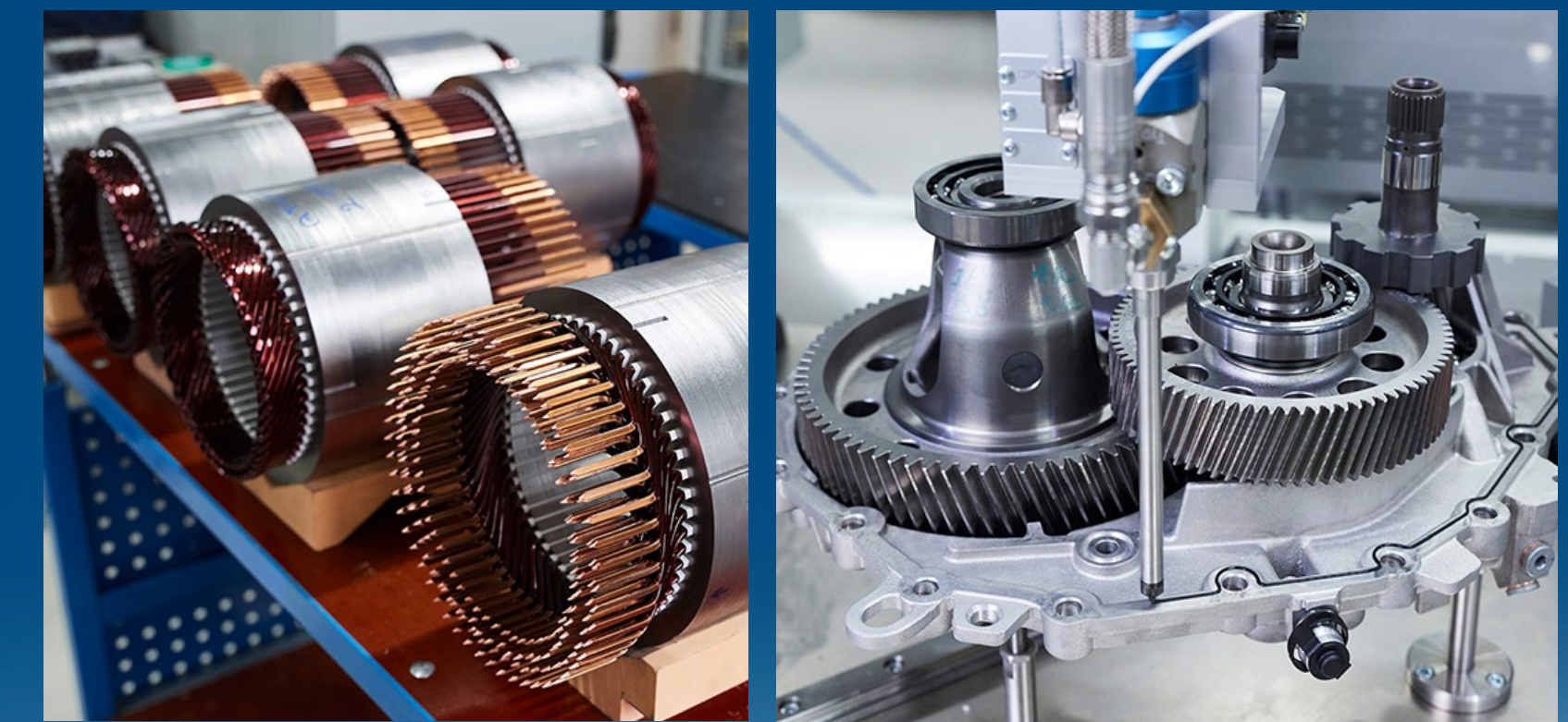
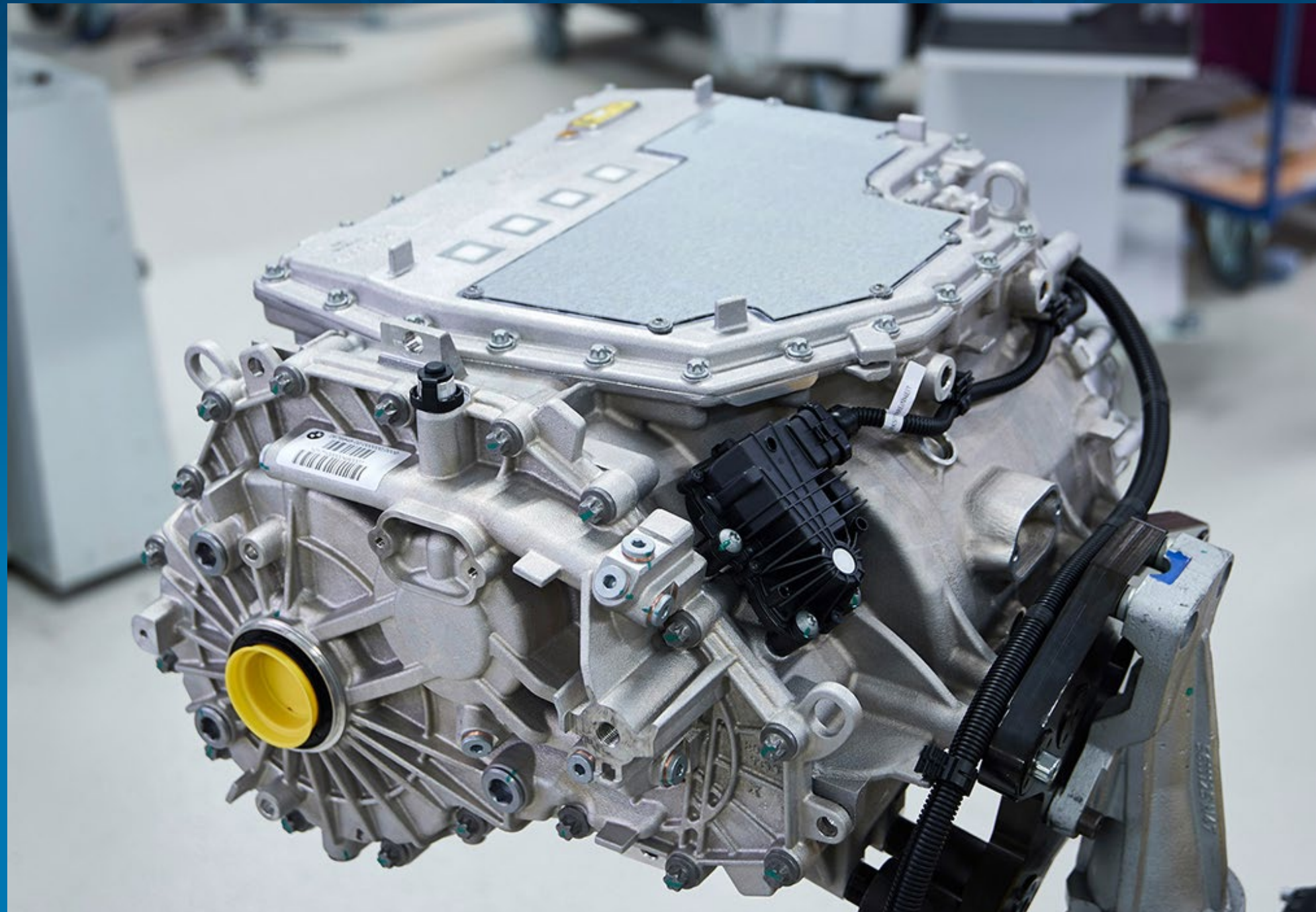

- In-house development and production of batteries since 2008.
- Further optimisation of interaction between the electric motor, transmission, power electronics, and battery.
- Electric motor without the use of rare earths.

- Electric motor, transmission and power electronics in a compact unit.

THE FIRST-EVER BMW i4 M50. 5TH GENERATION HIGHLY INTEGRATED DRIVE UNIT.

➤ ESM Technology: Electrically excited Synchronous Motor:

- Silent operation, exceptional balance between high peak power and stable torque even at high rpm.
- Avoids magnets and therefore rare-earth materials.

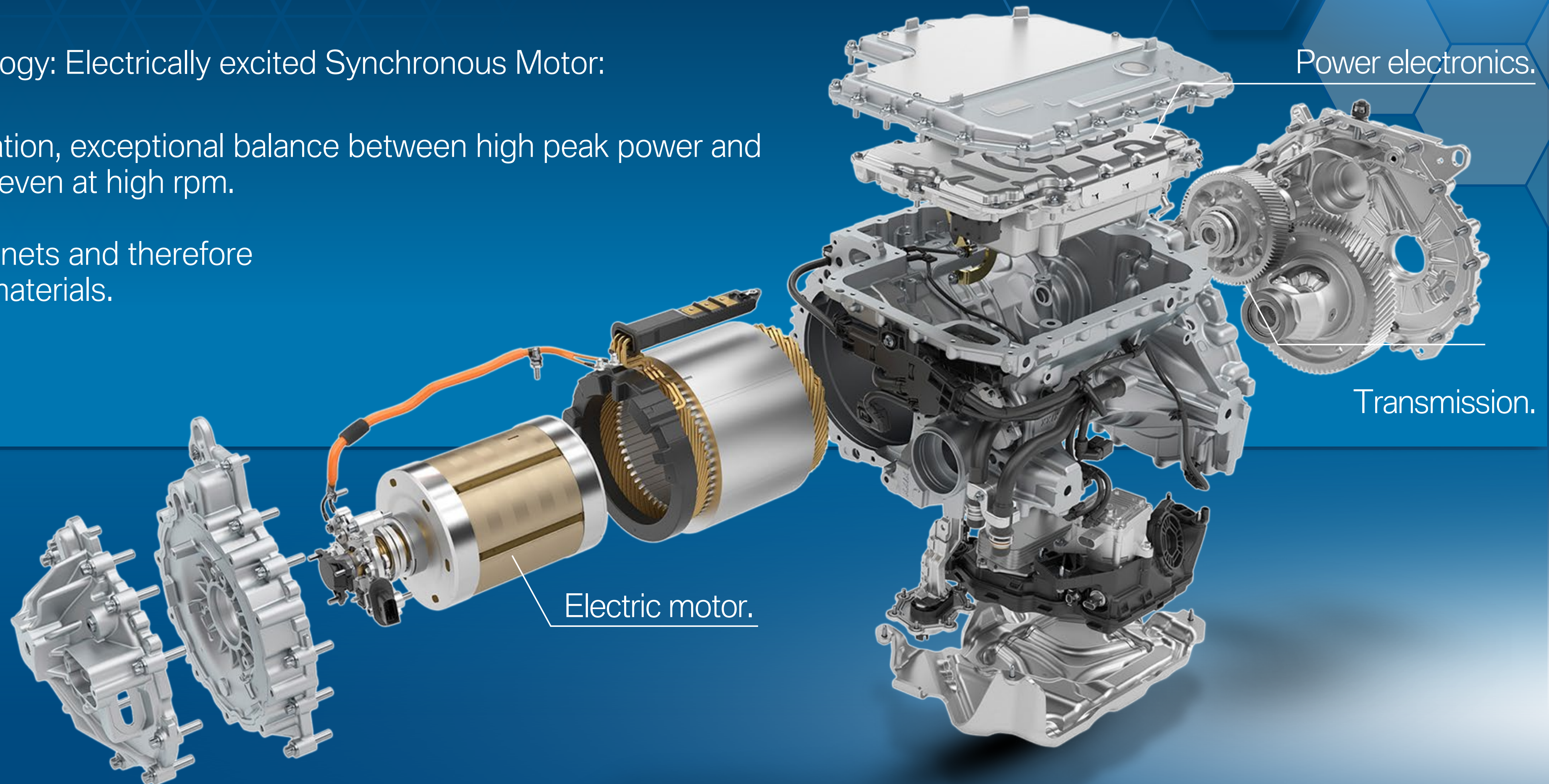

THE FIRST-EVER BMW i4 M50. ADVANCED BATTERY CELL TECHNOLOGY.

- Modular System: e.g. allowing with a 110mm cell a Gran Coupé silhouette for the BMW i4 or with a 140mm cell a SAV silhouette for the BMW iX.
- Lithium-ion technology with Prismatic cells with Nickel-rich cell chemistry.
- Each cell individually controlled and modules easy to exchange.

Cell-surveillance.

Cell modules.

Battery
Management Unit.

Cooling plates.

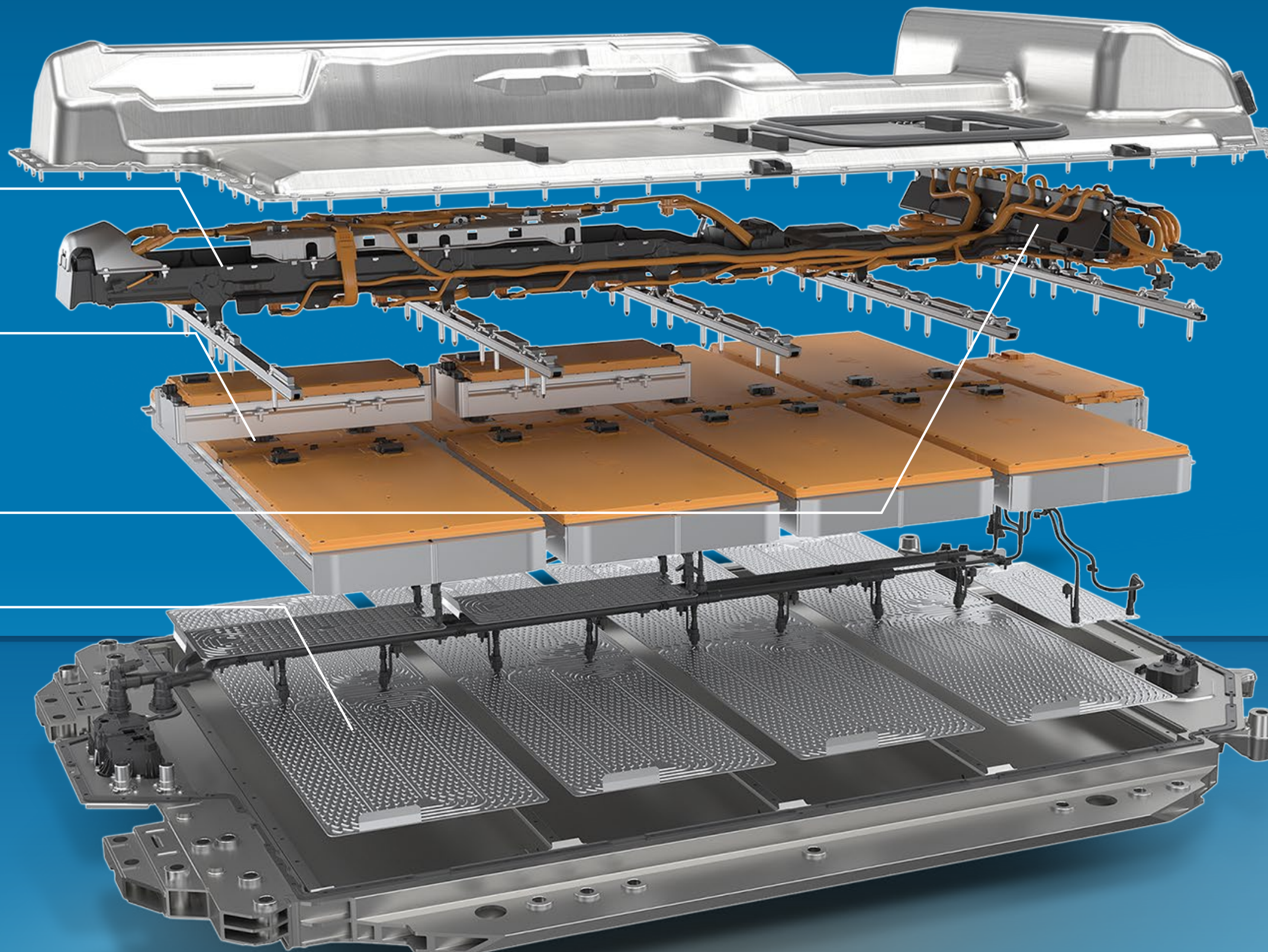

BMW i4 ENERGY CAPACITY

BMW i4 (eDrive40
and M50)

83.9 kWh (gross)
80.7 kWh (net)



BMW GEN5: HIGH VOLTAGE BATTERY – SUSTAINABILITY FOCUSED.

- BMW steered and controlled Cobalt and Lithium sourcing.
- CO₂-free production of battery cells - only using green power.
- Our target: use of more than 90% recycled Nickel, Cobalt and Aluminium by 2030.

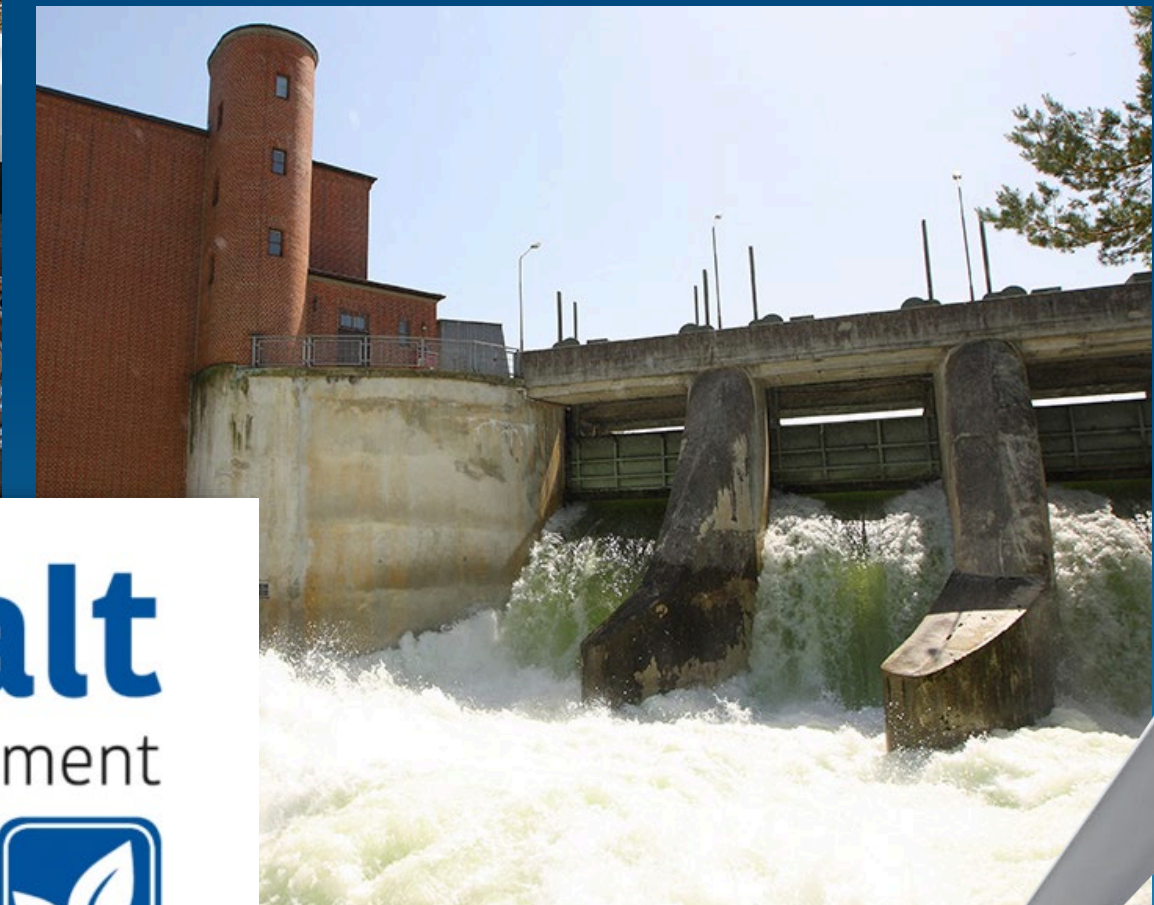
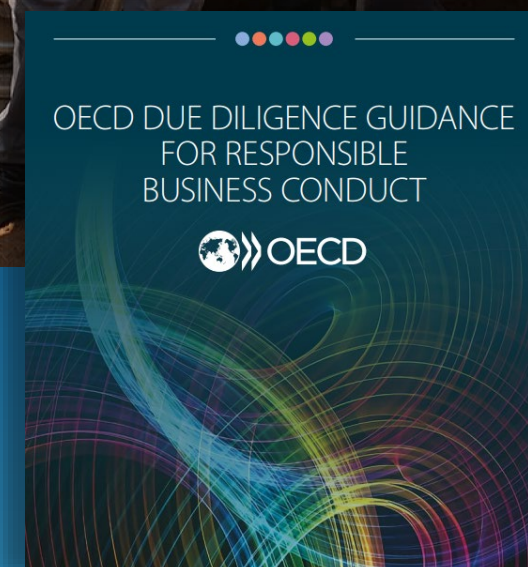

THANK YOU.

